

ZEBRONICS

Smart LED Projector

PixaPlay[®] 66



User Manual

www.zebronics.com

Dear Customer,

Thank you for purchasing the **ZEB-Pixaplay 66** Smart LED Projector. Please read the user manual carefully before usage& save it for future reference.

Note:

- *To provide a stable power supply, kindly use the cable provided with the product and connect to a AC 100-240V, 50/60Hz power source.*
- *Avoid the self-disassembly of the product as it results in the failure of Warranty.*
- *Avoid looking directly at the projector lens while it is active.*
- *Make sure that the projector's air vents are not blocked while in use. The device must be kept in a well ventilated surrounding for proper functioning.*
- *It is recommended to power OFF the projector after a continuous usage of 6 hours.*
- *Place the projector away from water or other liquids. Avoid water accumulation and ensure good ventilation.*
- *In case of enquiry regarding the projector, email us at enquiry@zebronics.com or contact us at 044 4000 0004.*

Features

- Home Theater Projectors for Movies, TV & Gaming etc.,
- Built in Speaker
- Wide Compatibility
- Auto Focus Technology
- Auto Keystone Adaptation
- Auto Obstacle detection & Auto Screen Fit
- Remote Control
- Miracast
- IOS Screen mirroring
- Dual band Connectivity (2.4GHz & 5GHz)
- FHD1080p (Native)
- APP Support
- Touch control

Specification

Model No	: ZEB- SLP 2
Screen size	: 124 - 508cm
Native Resolution	: 1920 x 1080 FHD
Max. Supported Resolution	: 1080p (Max.)
Android version	: 12
RAM	: 1GB

Core Processor : Quad Core Processor

Storage (ROM) : 8 GB

Wi-Fi Connectivity : Dual band
Connectivity
(2.4GHz & 5GH)

Bluetooth Version : v5.1

Display technology : LED

Lifespan : 30,000h

Brightness : 9500 lumens

Contrast ratio : 1000:1

Projection Distance: 1.5m - 5.9m

Port Interface : HDMI (ARC) x 2,
USB x 2, AUX OUT

Video file format : AVI, MP4, MPG, MKV,
MOV, FLV, 3G2, VOB,
SWF, TS

Input Voltage : AC 100-240V, 50/60Hz

Product Dimension : 25.6 x 20.8x 8.8 cm
(W x D x H)

Package Dimension: 31.5 x 26.5 x 18.3 cm
(W x D x H)

Net. weight : 1.92Kg

County of origin : PRC

Package Contents:

Projector	: 1 U
Remote Control	: 1 U
Power Cord	: 1 U
Cotton Swab Pack	: 1 U
HDMI Cable	: 1 U
QR Code Guide	: 1 U

Remote Control

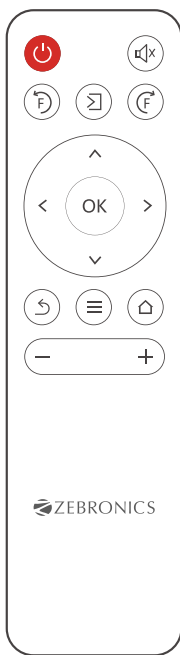

Power button

Turn on/off



Mute button

Mute



Focus button

Adjust focal distance



Signal source button

Choose to enter the Application Centre, HDMI



Return button

Return to last step



Menu button

Enter the setting page



Home button

Short press and return to the homepage



Direction buttons

▲ Up ▼ Down
◀ Left ▶ Right
● OK



Volume button

Volume-, Volume+

Button & Port Description

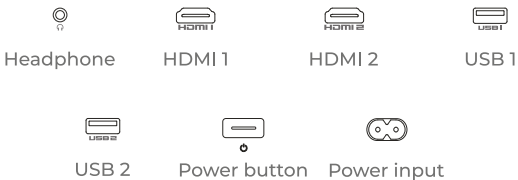
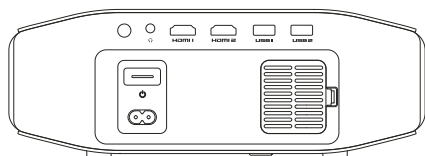
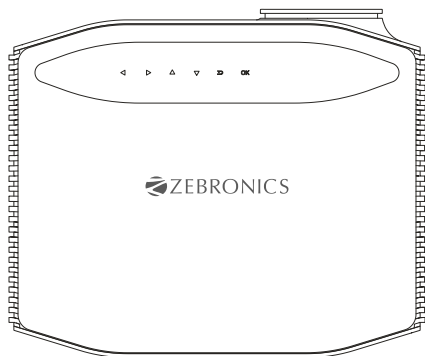

Setting up the projector

1. Connect the power cord to the socket of the projector and turn it ON.
2. Before turning ON, make sure to place it in a flat surface for a proper projection then press the power button/turn it on by using the remote.
3. Align the projectors as shown in the image below to ensure proper projection.

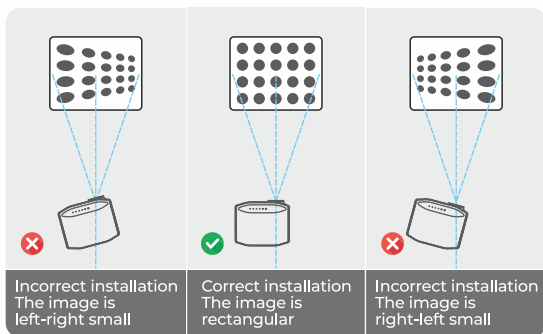

Auto Focus

Auto focus feature allows the device to automatically adjust the lens to ensure a sharp image on the screen. This is particularly useful in settings where the

projector might be moved or where the distance to the screen can vary.

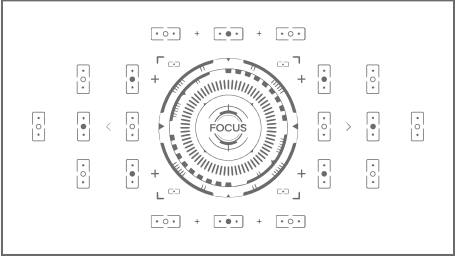

Auto Keystone

Auto keystone correction feature automatically adjusts the image to ensure it appears rectangular, even if the projector is angled or not positioned directly in front of the screen. This is particularly helpful when the projector is set up on a table or mounted at an angle

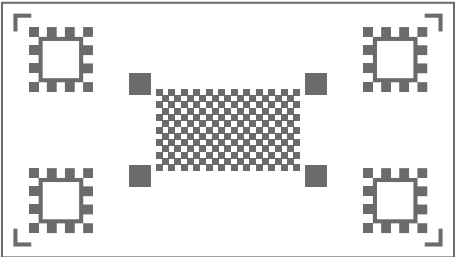

Electronic Focus

Press the “” “” to adjust the Focus manually

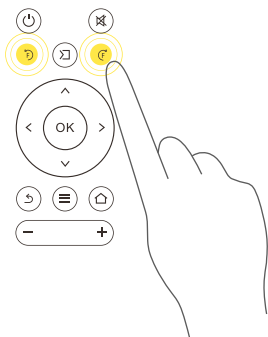
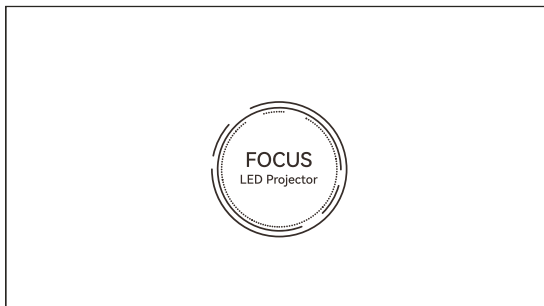

USB Interface

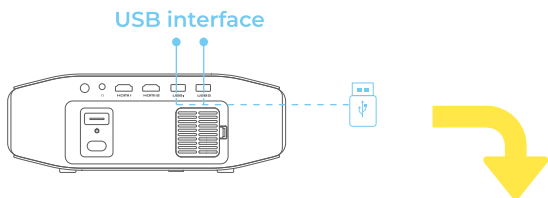

• Select Setting > USB

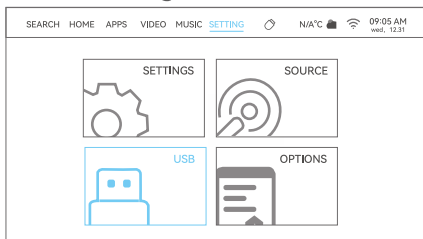

HDMI Interface

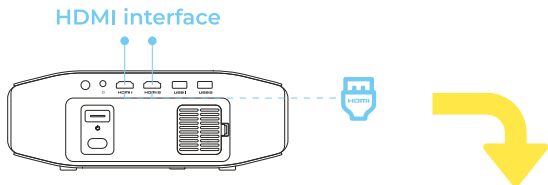

• Select SOURCE

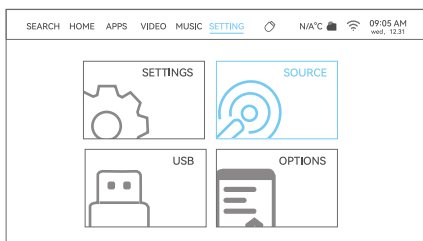

Settings

Open the homepage and select Settings. This setting houses the following sub-menus: Wifi Setting, Bluetooth Setting, Projection Settings, System Update, Other Settings and About.

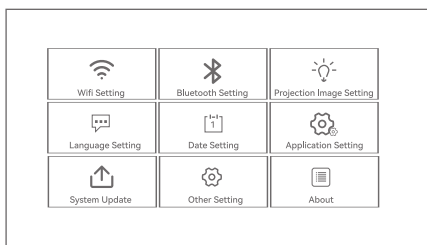
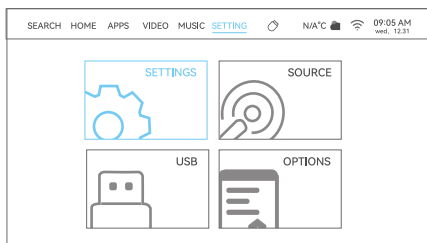

Projector distance & size

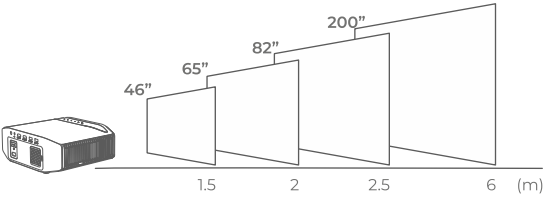

Note:

Due to optical device error of about 3%, the above data is for reference only, Please use actual measurement when installing the device.

ISO 9001:2015 Certified Company
www.zebronics.com

