

ZEBRONICS

Smart LED Projector

PixaPlay[®] 68



User Manual

www.zebronics.com

Dear Customer,

Thank you for purchasing the **ZEB-Pixaplay 68** Smart LED Projector. Please read the user manual carefully before usage& save it for future reference.

Note:

- *To provide a stable power supply, kindly use the cable provided with the product and connect to a (AC 100-240V, 50/60 Hz) power source.*
- *Avoid the self-disassembly of the product as it results in the failure of Warranty.*
- *Avoid looking directly at the projector lens while it is active.*
- *Make sure that the projector's air vents are not blocked while in use. The device must be kept in a well ventilated surrounding for proper functioning.*
- *It is recommended to power OFF the projector after a continuous usage of 6 hours.*
- *Place the projector away from water or other liquids. Avoid water accumulation and ensure good ventilation.*
- *In case of enquiry regarding the projector, email us at enquiry@zebronics.com or contact us at 044 40000004*

Features

- Home Theater Projectors for Movies, TV & Gaming etc..
- Built in Speaker
- Wide Compatibility
- Auto Focus Technology
- Auto Keystone Adaptation
- Auto Obstacle detection & Auto Screen Fit
- Remote Control (BT + IR)
- Miracast
- IOS Screen mirroring
- Dual band Connectivity (2.4GHz & 5GHz)
- FHD1080p (Native)
- APP Support
- Dolby Audio

Specification

Screen size	:114 - 508cm
Native Resolution	:1920 x 1080 FHD
Max. Supported Resolution	: 1080p (Max.)
Android version	:12
RAM	:2 GB
Core Processor	:Quad Core Processor

Storage (ROM) : 64 GB

Wi-Fi Connectivity : Dual band
Connectivity
(2.4GHz & 5GHz)

Bluetooth Version : v5.0

Display technology : LED

Lifespan : 30,000h

Brightness : 13500 lumens

Contrast ratio : 1000:1

Projection Distance : 1.5m - 6 m

Port Interface : AUX OUT, USB x 2,
HDMI x 2, RJ45 x 1

Video file format : AVI, Mp4, MKV, FLV,
MOV, 3G2, MPG, VOB,
SWF, TS

Input Voltage : AC 100-240V,
50/60Hz

Product Dimension : 27 x 25 x 15.5 cm
(W x D x H)

Package Dimension : 32.5 x 30.7 x 24 cm
(W x D x H)

Net. weight : 3.6Kg

County of origin : PRC

Package Contents:

Projector	:1 U
Remote Control	:1 U
Power Cord	:1 U
Cotton Swab Pack	:1 U
HDMI Cable	:1 U
QR Code Guide	:1 U

Product Description

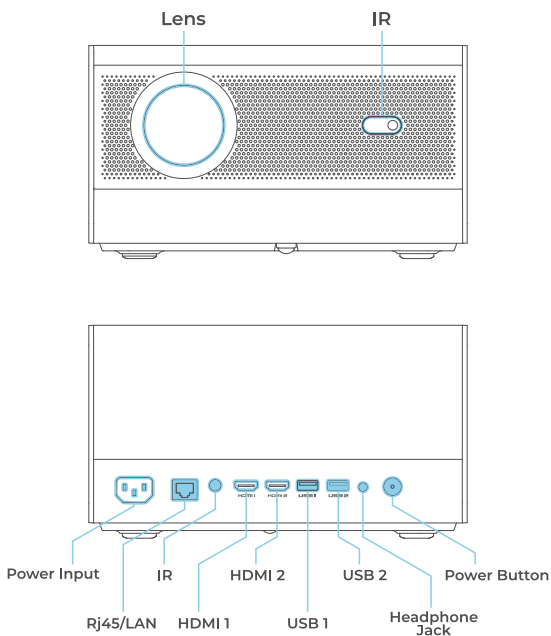

Remote Control

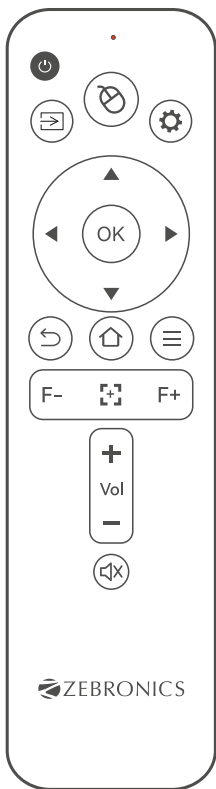

Power button

Turn on/off



Input button

Choose to enter the HDMI 1, HDMI 2 & USB



Mouse mode switching button

After switching, you can move the cursor with the up, down, left and right buttons and confirm with the OK button



Setting button

Enter the setting screen



Direction buttons

▲ Up ▼ Down
◀ Left ▶ Right
● OK



Return button

Returns to last step



Home button

Short press and return to the home page



Menu button

Enter the setting page



Focus button

Adjust focal distance



Auto Focus button

One-touch auto focus



Volume button

Volume-, Volume+



Mute button

Mute

Setting up the Projector

- 1 Connect the power cord to the socket of the projector and turn it ON
- 2 Before turning ON, make sure to place it in a flat surface for a proper projection then press the power button/turn it on by using the remote.
- 3 Align the projectors as shown in the image below to ensure proper projection

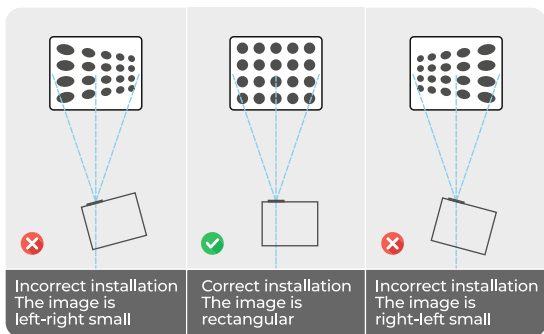

Projection Distance & Size

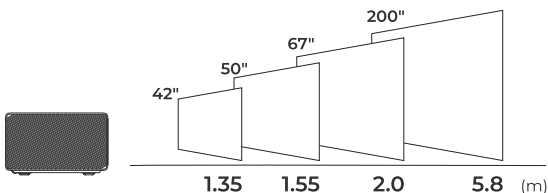

Projection Modes

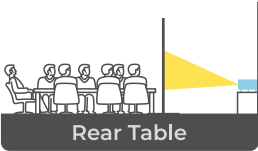
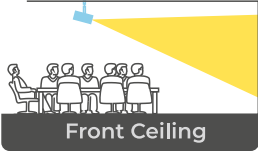
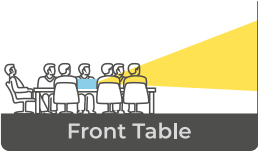

Input Source

1. HDMI Interface

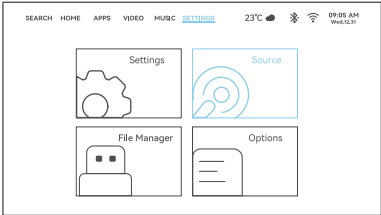
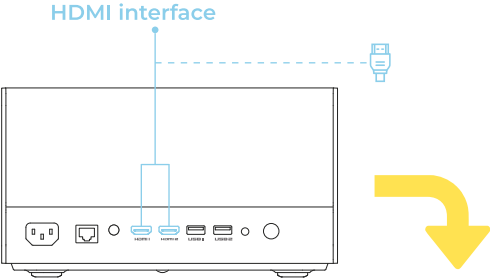

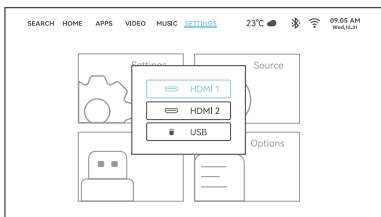

2. USB Interface

USB interface

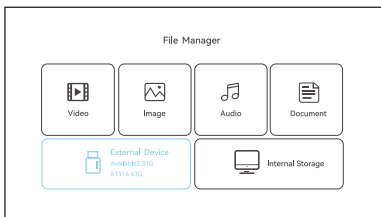
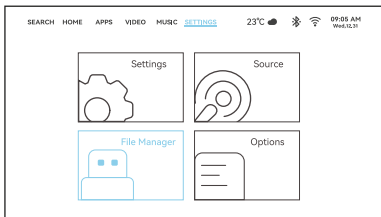
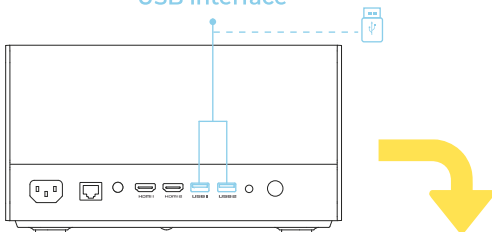

Bluetooth Settings

- Go to settings click Bluetooth
- Turn the Bluetooth Connection on and search for nearby Bluetooth devices
- Choose correct Bluetooth device to connect

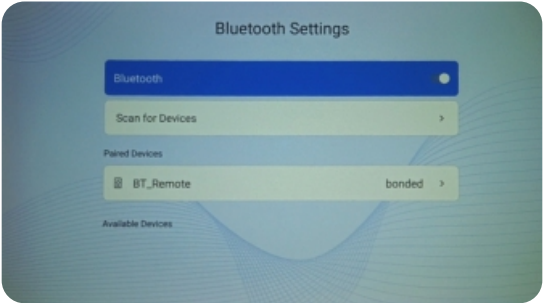
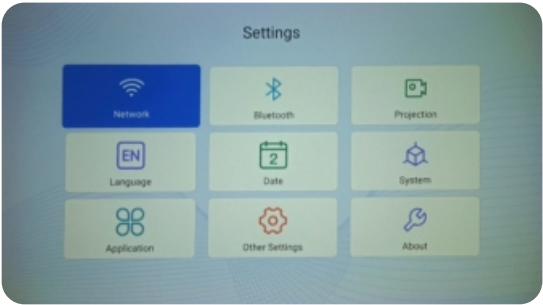

In the apps Speaker Mode is available by entering into speaker mode select Bluetooth speaker on your source device and then projector will act as a Bluetooth speaker



Projection Settings

1. Auto Focus

By default, the auto focus mode of the projector is enabled, allowing it to quickly detect and adjust to the optimal clarity of the screen when it is turned on.

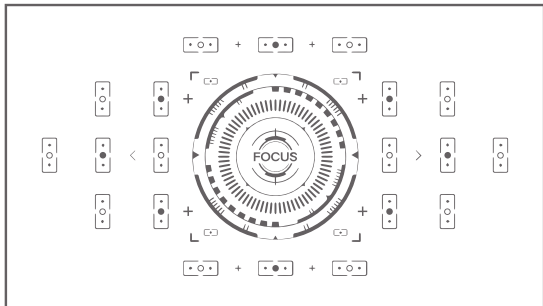

2. Electronic Focus

Press the F+ button and F- button in the remote to adjust the picture clarity



3. Auto Keystone

Auto keystone correction feature automatically adjusts the image to ensure it appears rectangular, even if the projector is angled or not positioned directly in front of the screen. This is particularly helpful when the projector is set up on a table or mounted at an angle

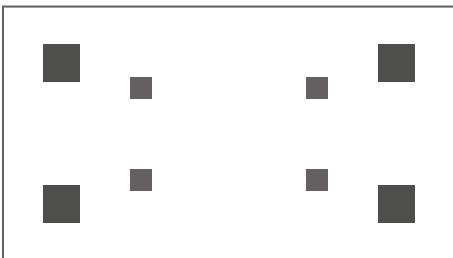

4. Miracast connection

First Step

Choose the corresponding miracast methods

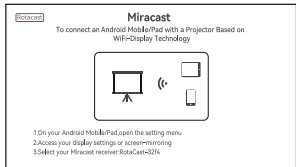
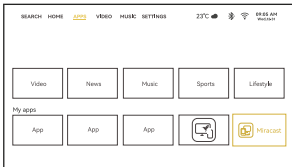
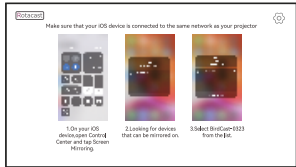
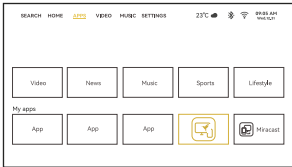

5. Digital Zoom

- Go to Settings - Projection Settings
- Choose Digital Zoom
- Press Down button V to Zoom out (100%-70%) and Up button A to Zoom in (70%-100%)



Wi-Fi Connections

1. Wi-Fi Connection:

- Go to Homepage > Settings - WIFI Setting
- Turn the WIFI ON and search the WIFI list by "Add WIFI"
- Select your WIFI then enter password to connect

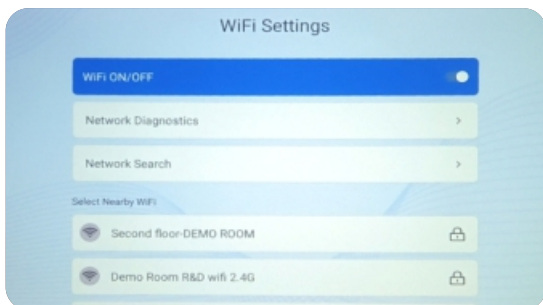

2. Wired Connection:

- Go to Homepage -> Setup > Network > Wired Setting > Ethernet Setting > Auto IP (On)
- Insert the wired cable into the LAN interface of the projector to use the wired network

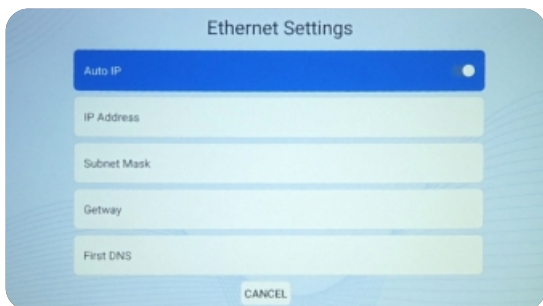

3. Hotspot Connection:

- Go to Homepage > Settings > Network > Hotspot

Hotspot Setting

Hotspot Switch

Hotspot Name AndroidAP_3194

Type of Security: WPA/WPA2

Hotspot Password

Show Password

CANCEL SAVE

ISO 9001:2015 Certified Company
www.zebronics.com