

 ZEBRONICS

T R I M M E R  
ZEB **HT104**



**User Manual**

[www.zebtronics.com](http://www.zebtronics.com)

Thank you for purchasing **ZEB-HT104** Trimmer. Please read the user manual carefully before usage & save it for future reference.

**Note:**

- Use this product only for its intended use.
- Do not dismantle the trimmer in order to avoid electrical shock & other accidents and this may lead to devoid of warranty.
- Keep the product and cords away from high temperature and high humidity places.
- Avoid using and charging the product with wet hands.
- Do not throw the product into fire.

**Features:**

Upto 90mins Cordless use

Rounded tip blade

Self Sharpening Stainless steelblades

4 Guide combs (3 - 12mm)

LED Display

2 speed mode

Ergonomic design

Built in Rechargeable battery

**Specification :**

Input Voltage	: DC 5V
Usage type	: Corded & Cordless
Trimmer Body Material	: ABS
Trimming Range	: 0.7mm - 12mm
No of Guide	
Combs Attachments	: 4nos (3mm, 6mm, 9mm, 12 mm)
Blade material	: Stainless steel
Charging time	: Upto 90 mins
Run time	: Upto 90 mins
Power consumption	: 5W
Product dimension (W x D x H)	: 161 x 38 x 41 mm
Net Weight	: 135 g

## Product description :

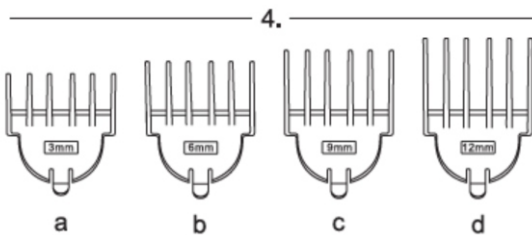
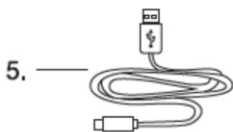
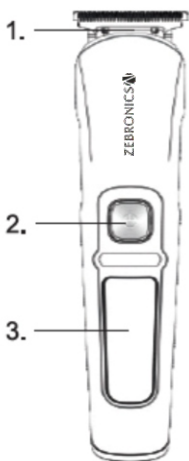

1. Trimmer Head
2. Power On/Off Switch
3. LED Display

4. Guide Combs
5. Charging Cable
6. Cleaning Brush
7. Oil

## Usage Instructions:

1. Fully charge the trimmer before every usage for better performance.
2. Add or remove the guide combs as per the levels of trimming needed.
3. Press the power button to switch the trimmer On/Off.

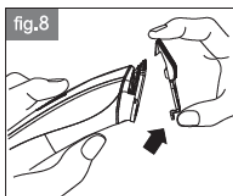
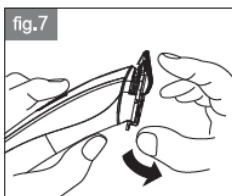
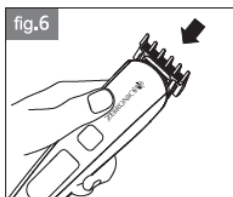
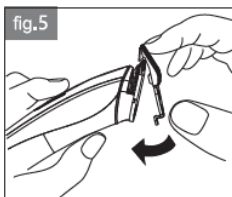
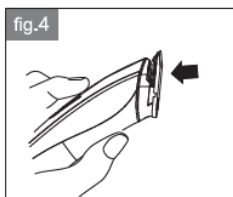
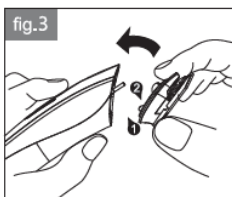
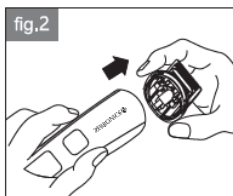
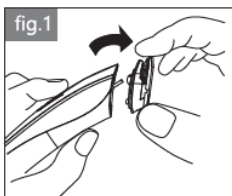

## **Cleaning the Trimmer after Usage:**

1. Kindly remove the trimmer head from the socket.
2. Use the brush to remove the hairs from the blades of the trimmer head.
3. Also, clean the head socket of the base with the brush to clean the hair particles.
4. Avoid the usage of the water or other cleaning liquid / solvents for cleaning the trimmer.

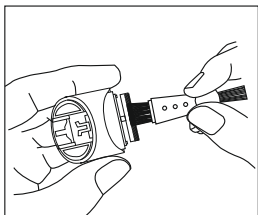
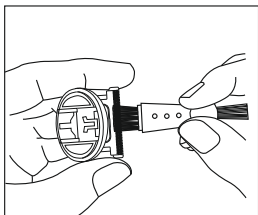

## **Charging Instruction:**

The trimmer can be charged with the charging cable that comes with the product. Connect the USB connector of the charging cable to the USB port of a DC5V charger and the other end to the trimmer. The LED display shows the battery percentage.