



6 in 1 Grooming Kit

ZEB HT106



User Manual

www.zebronics.com

Thank you for purchasing **ZEB-HT106** 6 in 1 Grooming Kit. Please read the user manual carefully before usage & save it for future reference.

Note:

- Use this product only for its intended use.
- Do not dismantle the trimmer in order to avoid electrical shock & other accidents and this may lead to devoid of warranty.
- Keep the product and cords away from high temperature and high humidity places.
- Avoid using and charging the product with wet hands.
- Do not throw the product into fire.

Features:

Upto 90mins Cordless use

4 Guide Combs (3 - 12 mm)

Rounded tip blade

Self Sharpening Stainless steelblades

Multiple Styling Tools

Detachable Clips & Heads

Ergonomic design

LED Indicator

2 speed mode

Built in Rechargeable battery

Specification :

Input Voltage	: DC 5V
Usage type	: Corded & Cordless
Trimmer Body	
Material	: ABS
Trimming Range	: 0.5mm - 12mm
No. of Clips	
Attachments	: 4+1
Styling tools	: Full size trimmer head, Precision Trimmer head, Design trimmer head, Micro Shaver head, Nose trimmer head, Body Trimmer
Blade material	: Stainless steel
Charging time	: Upto 90mins
Run time	: Upto 90mins
Power	
consumption	: 5W
Product dimension	: 163 x 39 x 42 mm
(W x D x H)	
Net Weight	: 145g

Product description :

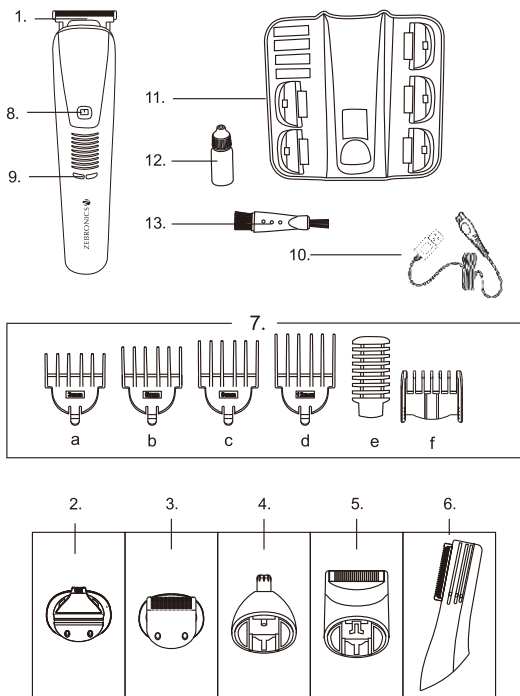

1. Full Size Trimmer Head
2. Precision Trimmer Head
3. Designer Trimmer Head
4. Nose Trimmer Head
5. Micro Shaver Head
6. Body Trimmer Head
7. Guide Combs
8. On/Off Switch
9. Charging Light Indication

10. Charging Cable
11. Base
12. Oil
13. Cleaning Brush

Changing the Trimmer heads:

1. To change the trimmer head, first switch the trimmer off and Place the thumb finger at the base of the head and use your index finger to pull out the head from the socket. (Refer Fig1, Fig2)
2. Now place the trimmer head that you want to Use on the trimmer base and gently press on head to fix it perfectly. (Refer Fig3, Fig4)

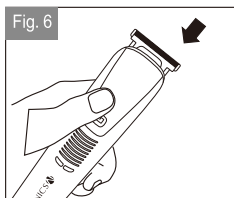
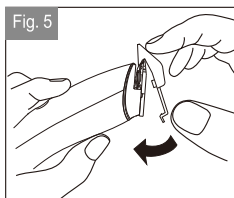
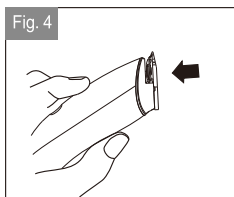
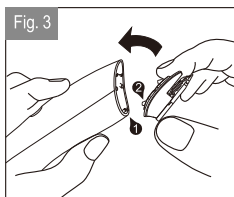
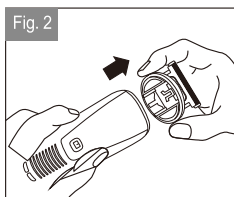
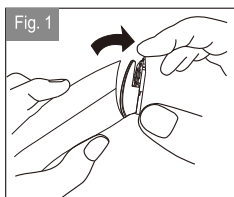

3. To add the trimmer clip, place the trimmer clip on the trimmer head and gently press the

base of the clip to the base of the trimmer head. (Refer Fig5)

4. Now switch On the trimmer by pressing the On / Off switch of the trimmer.

5. This is common for all the trimmer heads – Refer the following fig.

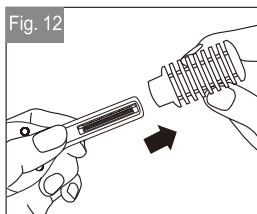
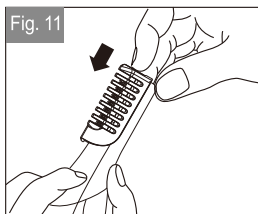
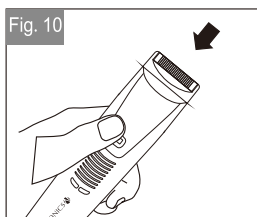
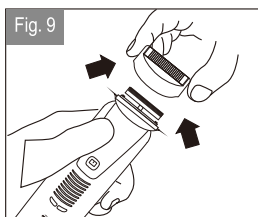
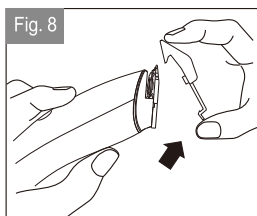
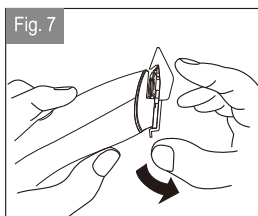

Cleaning the Trimmer after Usage:

1. Kindly remove the trimmer head from the socket.
2. Use the brush to remove the hairs from the blades of the trimmer head.
3. Also, clean the head socket of the base with the brush to remove the hair particles.
4. Avoid the usage of the water or other cleaning liquid / solvents for cleaning the trimmer.

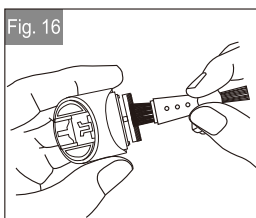
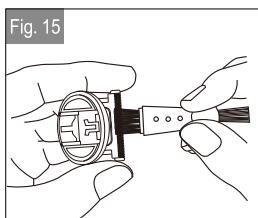

Charging instruction:

The trimmer can be charged with the charging cable that comes with the product. Connect the USB connector of the charging cable to the USB port of a DC5V charger and the other end to the trimmer. The red light below the On/Off switch indicated that the trimmer is charging and once fully charged the colour turns green.