



UNLEASH THE BOLD

10 in 1 Multi Grooming Kit
HT210
ZEB



User Manual

www.zebronics.com

Thank you for purchasing the **ZEB-HT210** Trimmer. Please read the user manual carefully before usage & save it for future reference.

Note:

- Use this product only for its intended use.
- Do not dismantle the trimmer in order to avoid electrical shock & other accidents and this may lead to void of warranty.
- Keep the product and cords away from high temperature and high humidity places.
- Avoid using and charging the product with wet hands.
- Do not throw the product into fire.

Features:

- Upto 120 mins Cordless use
- 2 Level Blade Precision
- Corded & Cordless usage
- Multistage Guide comb
- 4 Guides combs (3-12mm)
- Washable Blades & Attachments
- Self Sharpening Stainless steel blades
- LED Indicator
- 4 Additional heads
- Built in Rechargeable battery
- 90 mins USB Rapid Charge
- 10-in-1 Storage Dock

Specifications:

Input Voltage	: DC 5V
Usage type	: Corded & Cordless
Trimmer Body Material	: ABS Plastic
Trimming Range	: 3mm - 7mm
No of Clips Attachments	: 4nos (3/ 6/ 9/ 12mm) + 1no.(3/4/5/6mm)
Blade material	: Stainless Steel
Charging time	: Upto 90 mins
Run time	: Upto 120mins
Power consumption	: 2W
Product Dimension (W x D x H)	: 15.5 x 4.1 x 3.7 cm
Net Weight	: 127g

Package Contents:

Trimmer	: 1 U
Storage Dock	: 1 U
Charging Cable	: 1 U
Cleaning Brush	: 1 U
Additional heads	: 4 U
4 Guides combs (3,6,9,12mm)	: 4 U
Multistage Guide comb	: 1 U
Oil	: 1 U
QR code guide	: 1 U

Product Description:

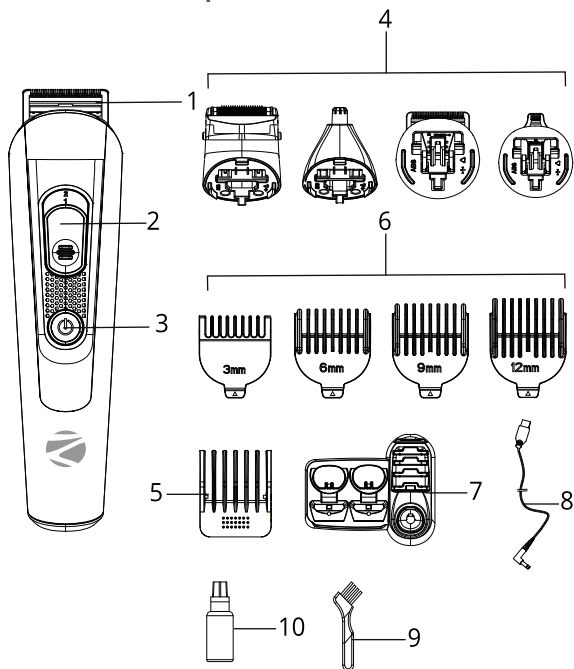

1. Trimmer Head
2. Level Slide Button
3. Power Slide Button
4. Additional Heads
5. Multistage Guide Comb
6. Guide Combs
7. Storage Dock
8. Charging Cable
9. Cleaning Brush
10. Oil

Usage Instructions:

1. Fully charge the trimmer before every usage for better performance.
2. Add or remove the guide comb as per the levels of trimming needed.
3. Short Press the power button to switch the trimmer On/Off.
4. Long Press the power button to turn On/Off the travel friendly mode.
5. Slide the Level button to adjust between different trimming levels of the Trimmer.

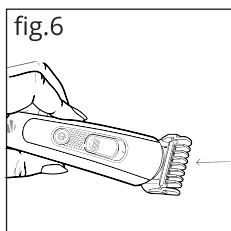
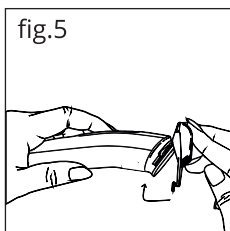
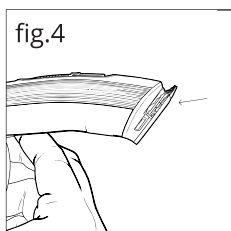
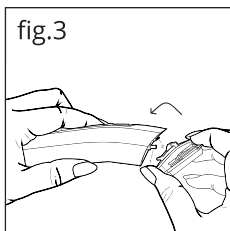
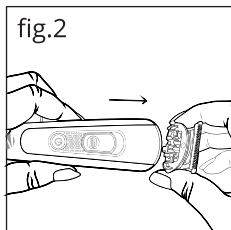

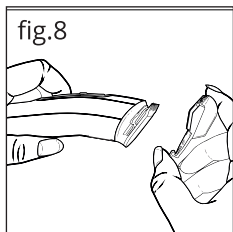
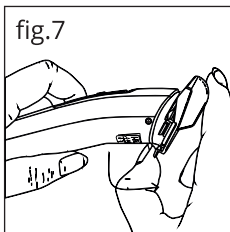

Cleaning the Trimmer after Usage:

1. Kindly remove the trimmer head from the socket.
2. Use the brush to remove the hairs from the blades of the trimmer head.
3. Also, clean the head socket of the base with the brush to clean the hair particles.
4. Avoid the usage of the water or other cleaning liquid / solvents for cleaning the trimmer.

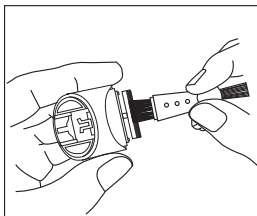
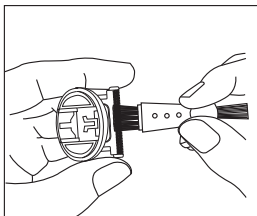

Charging Instruction:

The trimmer can be charged with the charging cable that comes with the product. Connect the Barrel connector of the charging cable to the Barrel port of a DC 5V charger and the other end to the trimmer.

Charging Instruction via Charging Dock:

First try to insert your charging cable at the bottom of the storage dock like the below images:

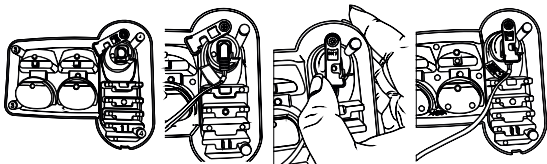

Plug the trimmer into the Barrel Charging Dock and Connect the Barrel Charging Dock with the provided cable.

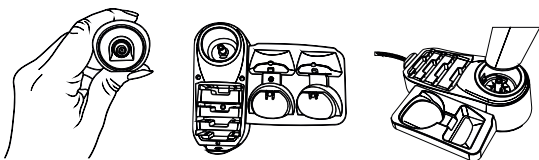

Now, connect the Barrel connector of the charging cable to the USB port of a DC 5V charger and the other end to the trimmer.