



Selfie Ring Light With Tripod

ZEB **RL10**



User Manual

www.zebronics.com

Thank you for purchasing **ZEB-RL10** Selfie Ring Light. Please read the instructions carefully before use.

Specifications

Ring light size:	: 254mm (10)
Outer Dia (mm)	: 260
Inner Dia (mm)	: 200
Power Input	: DC 5V
Power Consumption	: 12W
No. of LEDs	:
White	: 120 nos.
RGB	: 30 nos.
No. of White	
Light modes	: 3 (Cool / Medium / Warm)
No. of RGB	
LED Modes	: 26
Brightness	: 1600 Lumens
Color temperature	: 3000K - 6500K
Dimensions	:
Ring	: 260 x 26 mm (Outer Dia x Thickness)
Tripod (Extended)	: 450 x 450 x 1600 mm (W x D x H)

Features

- 254mm (10) Ring light
- USB powered
- Low power consumption
- 6 feet extendable tripod
- Smart phone holder
- RGB LED modes
- 3 preset white light modes
- Remote control (with BT)
- Easy in-line control pod
- Multi level brightness control

Package contents

Ring light	: 1U
Extendable Tripod	: 1U
Hot shoe mount	: 1U
Smart phone mount	: 1U
Remote shutter controller	: 1U



Remote shutter controller

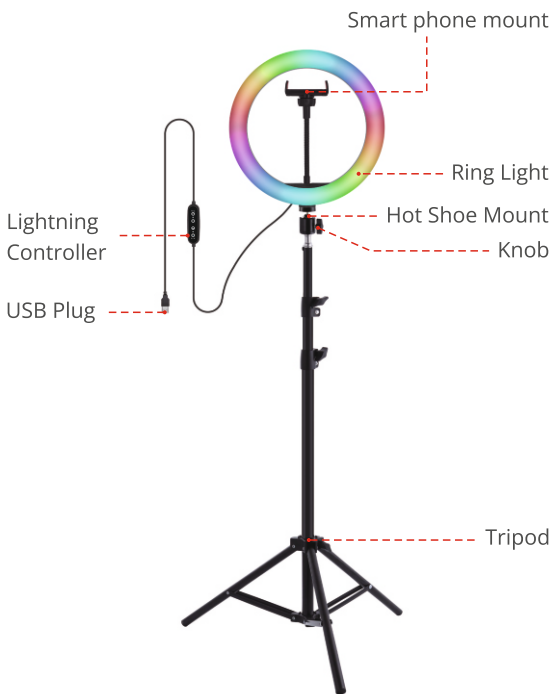

How to Install The Tripod



1. Unscrew the lowermost knob of the tripod counter-clockwise.

2. Pull the three legs of the tripod outward and move up and down.



3. After adjusting the three legs of the tripod to a stable angle, turn the knob clockwise.

4. Extend the tripod stick from bottom to top by unlocking the Knob, tighten the lock catch to fix the tripod stick at any desired height.

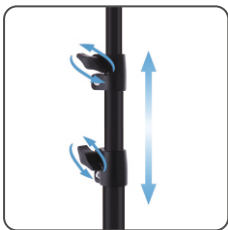

How to Install The Ring Light

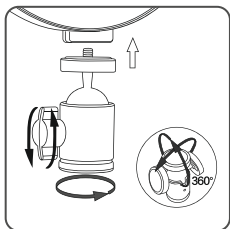

1. Insert the Tripod Ball Head into the screw hole of the ring light, screw the bottom of the Tripod Ball Head clockwise.

Note: Rotate the Tripod Ball Head, and the joint ball design allows the ring light to be adjusted to 360°. Then tighten the Tripod Ball Head.

2. Assemble the ring light with the Tripod Ball Head on the saddle plate through the screw.

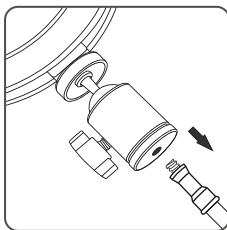

How to Use The Remote Shutter Control

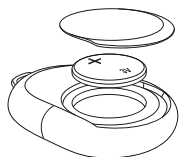
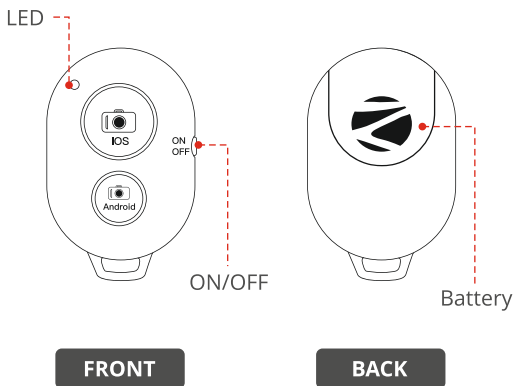

Battery Placement

STEP 1 : Turn on the side switch and the blue indicator light flashes.

STEP 2 : Turn on the phone BT and enter the BT setting interface.

STEP 3 : Find "ZEB-RL10" and click "ZEB-RL10". This process may take up to 3 seconds.

STEP 4 : Open the Camera APP on the phone and press the Button of the remote control to take photos.

How to Adjust The Brightness

1. Connect the USB plug to power supply (recommended 5VDC, 3A adapter)



USB Adapter



Portable Bank

2. Press the power key to turn on or off the Ring Light.

3. To adjust the brightness, press the + or - button.

Lighting Controller



4. You can press White / RGB button to adjust the color of light in Corresponding mode.



- 1 3 White Light Modes
- 2 26 RGB LED Modes

ISO 9001:2015 Certified Company
www.zebronics.com