



ZEBRONICS
ALWAYS AHEAD



User Manual

www.zebronics.com

Dear Customer,

Thank you for purchasing **ZEB-SOUND BOMB 1** (Wireless Earbuds). Please read this user manual carefully before operation & save this user manual for further reference.

Note:

- Avoid the use of this product at the high-temperature and high humidity environment.
- Avoid self-disassemble of product or it will result in the failure of warranty.
- Please charge the product with DC 5V power adapter.

Caution:

Listening at high volumes can cause hearing impairment. Please limit your usage time at high volumes.

Features

Wireless Stereo sound

Upto 12h* Battery life with charging case

Voice assistant support

Splash proof

Call function

Type-C Charging

Built-In Rechargeable battery

Specifications

BT Version	: 5.2
Supported BT Profile	: HSP / HFP / A2DP / AVRCP
Drive size	: 6mm
Speaker impedance	: 16Ω
Playback time	: 3.5 h*
Charging time	
Earphone	: 45mins
Case	: 1.5h
Talk time	: 2-3 h
Standby time	: 6-8 h
Case dimension	: 56.5 x 30mm (Dia x H)
Net. weight	: 45g

Package contents

Earbuds	: 2 U
Charging case	: 1 U
Eartips	: 4 U
Charging cable	: 1 U
QR Code guide	: 1 U

**at 50% Volume*

Product Representation

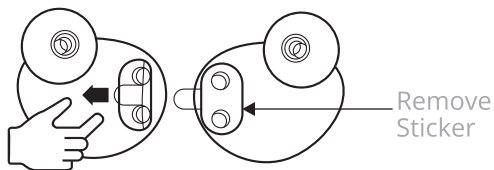
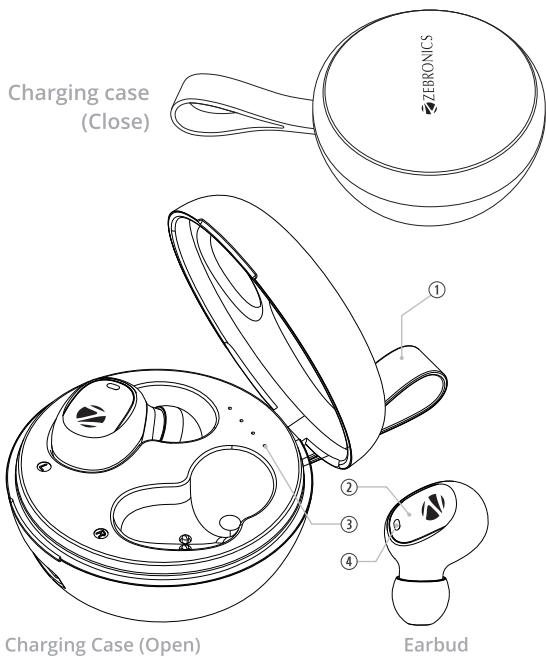

Note:

Remove the protective charging terminal sticker placed on the bottom of the Earbuds for charging the Earbuds.

- | | |
|--------------------------------|-------------------|
| 1. Tag | 3. LED Indication |
| 2. Multi Function Button (MFB) | 4. LED Indicator |

During Music Playback:

Tap the MFB once on either Left/Right side earbud to Play/Pause the track.

Double tap MFB to skip to Prev track on Left Earbud & Next track on Right Earbud.

During Calls:

Tap the MFB on either Left / Right side earbud once to attend an incoming call / end the call.

Tap and hold the MFB on either Left / Right side earbud for 2secs to reject an incoming call.

Usage Instruction:

Bluetooth Pairing Instructions:

Step 1: The Earbuds would power ON once they are taken out from the charging case.

Step 2: RED and WHITE LED would start blinking on both the earbuds. Both of the earbuds would automatically pair with each other within 5 secs. Once they are paired with each other, one of the earpiece would show a RED and WHITE LED blinking alternatively which means they are ready to pair.

Step 3: Now switch ON BT in your smart phone and search for nearby devices and pair with the BT name **ZEB-SOUND BOMB 1**.

How to use single Earbud:

Take one Earbud out either Left/Right from charging case. RED and WHITE LED blinking alternatively which means it is ready to pair. Now switch ON BT in your smart phone and search for nearby devices and pair with the BT name **ZEB-SOUND BOMB 1**.

Activating Voice Assistant:

Once connecting the earbuds via BT, long press the left earbuds for 2 secs to wake up the Voice Assistance of your smart phone.

Charging instruction:

Charging the Case:

Connect Type-C cable to the charging port of the charging case & connect the other end of the cable to a 5V DC adapter.

The charging case LED's indication will flashes WHITE indicating that it is charging. When WHITE LED's glows constant indicating that charging case is full.

Charging the Earbuds:

Put the earbuds in their respective charging slots in the charging case. Once placed inside the case and the earbuds will start charging automatically.

The LED Indicator will glow RED indicating that they are charging. RED LED indicator will goes OFF indicating that they are fully charged. When RED LED flash's on the earbuds at low battery.