

ZEBRONICS

DJ Speaker

ZEB **ROXOR** *Pro*



 **Dolby**
AUDIO

User Manual

www.zebronics.com

Important Safety Instruction

Thank you for purchasing the **ZEB-ROXOR PRO** DJ Speaker. Please read this user manual carefully and keep for future reference.

Warning

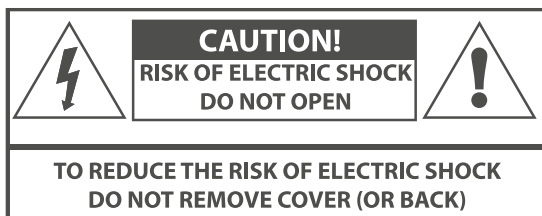

Caution:

- To reduce the risk of electric shock, do not dismantle the product and do not expose the unit to rain or moisture. The unit has no user-serviceable parts inside.
- Refer servicing to qualified personnel only.



The lightning flash within an equilateral triangle is intended to alert you to the presence of uninsulated dangerous voltage within the product's enclosure that may be of sufficient magnitude to constitute an electric shock to a person or persons.



Important! This symbol alerts you to read and observe important warnings and instructions on the unit or in this manual.

Notice:

1. To prevent possible hearing damage, do not listen at high volume levels for long time periods or a sudden high volume level.



2. Never use the device unsupervised! Switch off the device whenever you are not using it, even if not using it only for a short while.

3. The unit is not intended to be operated by means of an external timer or separate remote control system.

4. If the power supply cord is damaged, it must be replaced by the manufacturer, its service agent or similarly qualified persons in order to avoid a hazard.

5. Before operating this system, check the voltage of this system to see if it is identical to the voltage of your local power supply.
6. The unit should not be impeded by covering the ventilation opening with items such as newspaper, table-cloths, curtains etc. Make sure that there are at least 20 cm of space above and at least 5 cm of space on each side of the unit.
7. The unit must not be exposed to dripping or splashing. Do not place objects filled with liquids such as vases, bottles or humidifiers on the unit.
8. To prevent fire or shock hazard, do not expose this equipment to direct heat, rain, moisture or dust.
9. Do not locate this unit near any water sources e.g. taps, bathtubs, washing machines or swimming pools. Ensure that you place the unit on a dry, stable surface.
10. Do not place this unit close to a strong magnetic field.
11. Do not place the unit on a amplifier or receiver.
12. Do not place this unit in a damp area as the moisture will affect the life of electric components.
13. Do not attempt to clean the unit with chemical solvents as this might damage the finish. Wipe with a clean, dry or slightly damp cloth.

14. When removing the power plug from the wall outlet, always pull directly on the plug, never pull on the cord.

15. Depending on the electromagnetic waves used by a television broadcast, if a TV is turned on near this unit while it is also on, lines might appear on the LED TV. Neither this unit nor the TV is malfunctioning. If you see such lines, keep this unit well away from the TV set.

16. The mains plug is used to disconnect the device, the disconnected device should remain readily operable.

Important Safety Instructions

1. Read these instructions. Keep these instructions. Follow all instructions. Heed all warnings.

2. Only use attachments/accessories specified by the manufacturer.

3. Refer all servicing to qualified service personnel. Servicing is required when the Unit has been damaged in any way, for example, when the power-supply cord or plug is damaged, liquid has been spilled or objects have fallen into the Unit, the Unit has been exposed to rain or moisture, does not operate normally, or has been dropped.

4. The AC plug is used to disconnect the device, the disconnected device should remain readily operable. In order to disconnect the Unit from the AC power completely, the AC

plug must be removed from the AC outlet completely.

Power Source:

This speaker is designed to operate on standard AC Power strength. it works under 220V-240V ~ 50/60Hz (Speaker also have inbuilt batteries which will support device working while AC power off). Do not attempt to operate the DJ speaker on any other power source. You could cause damage to the DJ speaker which will void your warranty.

Preparation for Use

Unpacking and Set Up

- Remove the DJ speaker from the carton and remove all packing material from the DJ speaker. Save the packing material, if possible, in case the DJ speaker ever needs to be serviced or transported.
- The original carton and packing material is the only safe way to pack your DJ speaker to protect it from damage in transit.
- Remove any descriptive labels or stickers on the front or top of the devices' exterior casing.
- Do not remove any labels or stickers from the back or bottom of the the devices' exterior casing.

Setting the DJ Speaker

1. Plug the power cord into the mains.
2. Switch ON the DJ speaker on by pressing the power button on the DJ speaker or the Power button on the remote.
3. Select the input mode by pressing the input button again or by pressing the INPUT button on the remote.
4. Make your selection from the following input modes:

BT :BLUE

AUX :GREEN

ARC :CYAN

USB :PINK

5. To turn off, press and hold the POWER button on remote control or top panel for about 2 seconds, the DJ speaker will enter standby mode, and then unplug it from the wall outlet.

Product Representation

Top Panel

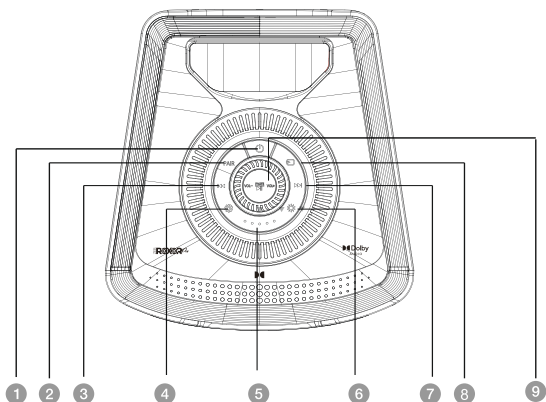

1. POWER
2. PAIR
3. PREV
4. EQ
5. INDICATOR
6. BREATHING LED LIGHT BUTTON
7. NEXT
8. INPUT
9. VOLUME KNOB | P/P BUTTON

1. **POWER** : When AC power supply is connected, press power button on the panel or remote control to start up. In the case of no AC power supply, long press power button on the control panel to power on & long press again to power off.

2. **PAIR** : Double short press for TWS Pairing & Long press connects to BT device & again Long press to disconnect the BT device.

3. **PREV** : Short press in BT and USB mode to switch the previous song. (No effect in other modes)

4. **EQ** : Long press for 2 seconds to toggle between 3 EQ modes & Short press to enter MIC, Treble, Bass setting mode. (Please refer below Indicator section for switching MIC, Treble & Bass adjustments)

5. **INDICATOR** : When EQ button is short pressed, Green LED Blinks in below pattern. Once selected, rotate volume knob to adjust the levels accordingly.

MIC VOL ● ○ ○ ○ ○

MIC TONE ○ ● ○ ○ ○

MIC ECHO ○ ○ ● ○ ○

MIC REVE ○ ○ ○ ● ○

BASS ● ● ○ ○ ○

TREBLE ○ ○ ○ ● ●

6. **Breathing LED light button** :

- Double short press to enter 4 LED modes + 1 OFF mode
 - LED Mode 1 – Top to Bottom bouncing LED depends on the music.
 - LED Mode 2 – Bottom to Top bouncing LED depends on the music.
 - LED Mode 3 – Top & Bottom to Center bouncing LED depends on the music.
 - LED Mode 4 – Colorful LED pattern.
 - LED Mode 5 – OFF mode
- In LED Mode 1, 2 & 3 - Short press to switch the color of the LED modes.
- Long press this button to instantly turn ON or OFF of the LED.

7. **NEXT** : Short press in BT and USB mode to switch the Next song. No effect in other modes.

8. **INPUT** : Short press to switch the input mode.

9. **Volume Knob | P/P Button** : Rotate knob is to adjust volume & Short press is play/pause in USB & BT Mode (Mute/unmute in ARC & AUX Modes)

LED Indicators

1. **Volume Level Indicator :**

When volume is increased the LED moves in the clockwise step by step & When volume is decreased the LED moves in the anticlockwise step by step indicating the volume level.

2. **LED Lights for Input modes :**

BT : BLUE

USB : PINK

ARC : CYAN

AUX : GREEN

3. **WHITE LED :** When the ARC is playing Dolby Audio, the indicator here is always lit in white indicating the Dolby Audio is decoded. When PCM signal is played it is displayed according to the normal light effect.

4. Bass, Treble and MIC adjustments are indicated by a white light from the center to the left and right, With the left being - and the right being +. The light is off to indicate that it is at zero.

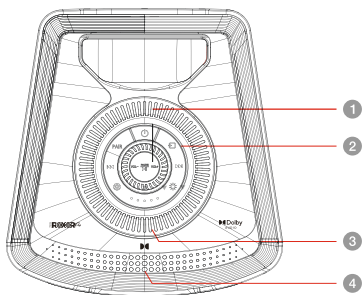

Remote Control

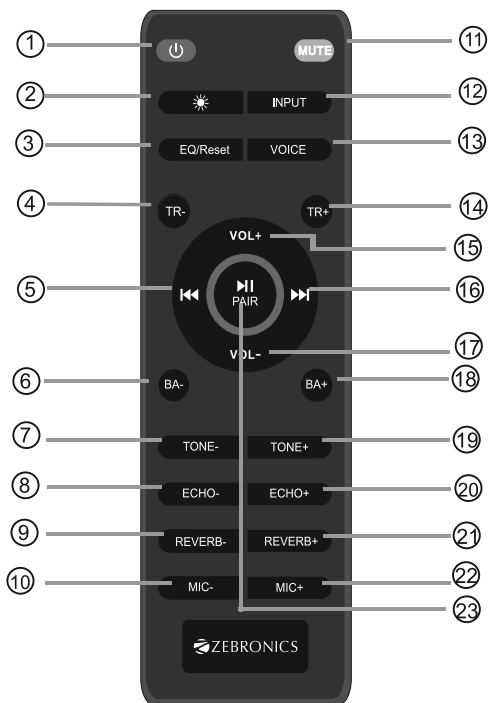

1. Power ON/OFF
2. LED : Short press is light color switching, two consecutive short presses is switching light modes, long press is light fast on/off.
3. EQ/Reset : Short press to toggle EQ, long press to reset.
4. Treble-
5. Previous : Short press in BT and USB mode to switch the previous song. No effect in other modes.
6. Bass-
7. MIC TONE-
8. MIC ECHO-
9. MIC REVERB-
10. MIC VOL-
11. MUTE
12. INPUT : Short press to switch input mode
13. VOICE : Short press to turn vocal remover on or off; vocal remover is off by default.
14. Treble+
15. VOL +
16. Next : Short press in BT and USB mode to switch to the next song. No effect in other modes
17. VOL -
18. Bass+
19. MIC TONE+
20. MIC ECHO+
21. MIC REVERB+
22. MIC VOL+
23. Play/Pause : In BT and USB mode short press is play/pause, long press is in BT disconnect/connect back. In AUX, TV(ARC) short press is mute/unmute.

Playing Audio via BT Connection

Through BT, connect the DJ speaker with your BT device and then you can listen to the audio files stored on the device through your DJ speaker.

1. Use either the "INPUT" button on the DJ speaker or the "INPUT" button on the remote to activate BT mode. The blue source LED light will be indicated that BT mode has been selected.
2. Activate the BT pairing function on your phone or other compatible device and select the BT list "**ZEB-ROXOR PRO**" from those devices.
3. When it is pairing or connecting, the blue LED light blinks, when successfully paired, the blue LED light will steady on with a beep.

Notes: 1. The above pairing procedure doesn't need to be repeated with the same connected device once paired. 2. If the connected device is switched off or manually disconnected, the DJ speaker will automatically enter pairing mode. If the connected device is moved away from wireless range (up to 10 meters) of the DJ speaker, then it will get disconnected, and it will successfully connect to the device once you re-enter BT range.

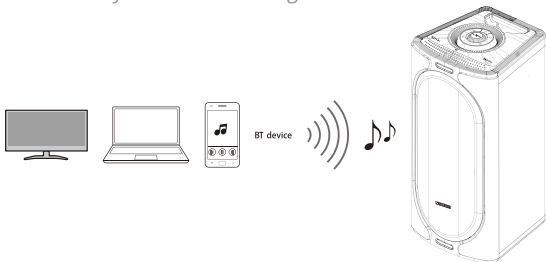

Playing Audio via USB Port :

When the USB flash drive is plugged in, the speaker automatically switches to USB input mode. A Pink LED indicator will indicate that USB mode has been selected. This mode cannot be selected on the DJ speaker or remote control unless it is connected to a USB flash drive.

1. Ensure that your USB flash drive contains MP3 audio files (other file types not supported)
2. Connect the USB flash drive to the USB port on the speaker (or your own USB extension cable connected to the USB port); music will automatically play.
3. The remote control includes USB input mode playback controls.

Playing Audio via AUX :

1. Use either the buttons on the DJ speaker or the "Input" button on the remote to activate AUX mode. A green LED indicator will indicate that AUX mode has been selected.
2. Playback functions (play/pause, tracks, pair) cannot be adjusted through the DJ speaker or remote when in AUX mode.

TV(ARC) Mode :

1. The DJ speaker supports TV(ARC) with audio return channel (ARC). You can hear the TV audio through your DJ speaker by using a single TV(ARC) cable. But on condition that

your TV is ARC compliant.

2. Using a high speed TV(ARC) cable, connect the TV(ARC) connector on the DJ speaker to the TV(ARC) connector on the TV. The TV(ARC) connector on the TV might be labeled differently. For details, see the user manual of your TV.

3. When TV(ARC) is connected, TV sound setting in "sound output" mode should be set as <external Dolby or Auto mode>, in addition, digital audio output mode should be set as <automatic> or <decoded output as Dolby>.

4. When the TV(ARC) cable is connected, the TV digital audio output is set as Dolby or Auto mode. Then start playing music on the TV.

5. Press "INPUT" button on the remote control or DJ speaker to select TV (ARC) LED Glow CYAN. Different TV might be different setting, please refer to your TV User Manual.

6. Use the volume buttons to adjust the volume to your requirements.

Note : 1. You can also change the audio settings by using the relevant buttons on the remote control. 2. When connecting a device such as a TV/Set-top box/Blue-Ray DVD/game console with TV(ARC) cable, set the audio output mode of the device to Dolby or Auto mode <digital TV(ARC) output>. 3. The TV is connected to a TV(ARC) port with DJ speaker. Different TVs might have different setup menus, but the operation approach is the same. 4. If needs to connect set-up box meanwhile, please firstly connect the TV(ARC) connector and paired to the DJ speaker. Then connect the set-top box.

DJ Speaker Connectivity

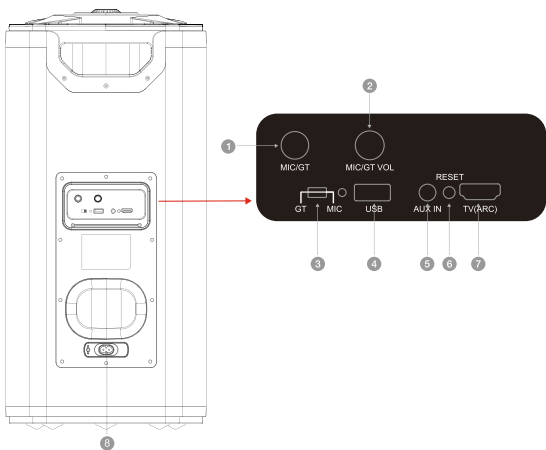
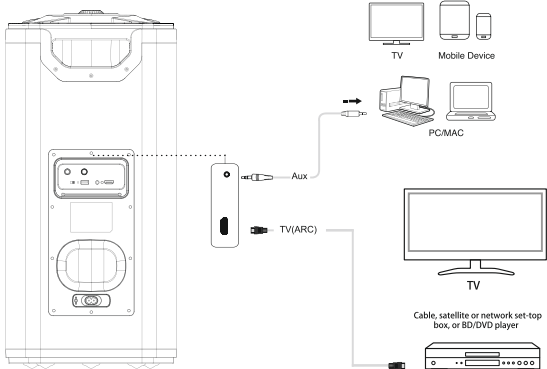

- | | |
|------------------|------------------|
| 1. MIC/GT | 2. MIC/GT VOLUME |
| 3. SWITCH MIC/GT | 4. USB |
| 5. AUX IN | 6. RESET |
| 7. TV(ARC) | 8. AC IN |

TWS Mode

1. Take two **ZEB-ROXOR PRO** speakers (Master speaker & secondary speaker) that you want to pair & keep both the speakers in BT mode which is indicated by the Blue blinking LED Indicator.
2. The master speaker should be in BT mode connected to a BT device at playback state, a double short press on the panel PAIR key the background light blinking, indicate the master speaker enter the TWS mode.
3. Now in secondary speaker (don't connect any BT device) short press the PAIR key 1 time, PAIR key background light flashes, indicating that the secondary speaker is in TWS Pair with master speaker. After TWS successful connected PAIR key background light is always ON.

Note: 1. After the secondary speaker is connected to the master speaker, it can only play the music of the master speaker. Cannot switch the input mode. 2. The master speaker is accessible in all modes. (The secondary speaker inputs or audio are not accessible until the TWS is unpaired but the LED modes can be adjusted in secondary speaker)

Features

- ◆ Multi Connectivity (BT v5.4 | HDMI (ARC) | USB | AUX IN)
- ◆ Dolby Audio
- ◆ Rechargeable Wireless MIC
- ◆ Dual Full range 16.51cm Drivers
- ◆ Guitar/Mic x 1 Inputs
- ◆ Up to 6h* Backup
- ◆ Karaoke Function
- ◆ LED Indicator
- ◆ RGB LED Lights with ON/OFF Switch
- ◆ Built-in Rechargeable Battery
- ◆ TWS Function
- ◆ Remote Control

Specification

Output Power (RMS) : 120W (60W+ 60W)

Driver Size

Full Range : 16.51cm x 2

Tweeter : 5.08cm x 2

Impedance

Full Range : 4Ω

Tweeter : 6Ω

Frequency Response : 45Hz-20kHz

S/N Ratio : ≥70dB

File Format Support : MP3 (USB)

Line Input : 3.5mm, HDMI (ARC)

Max Supported USB

Memory Size : 32GB

Charging Time : 1h 30 mins

Playback Time : 6h*

BT Name : ZEB-ROXOR PRO

BT version	: v5.4
Product Dimension (W x D x H)	: 29 x 30 x 60 cm
Net. Weight	: 9 kg

**at 50% Volume (LED OFF)*

Package Contents

DJ Speaker	: 1 U
Remote	: 1 U
Wireless Mic	: 1 U
Power Cord	: 1 U
Input Cable	: 1 U
HD Cable	: 1 U
QR Code Guide	: 1 U
Type C Charging Cable	: 1 U

Troubleshooting

PROBLEM/TROUBLE	POSSIBLE CAUSE	SOLUTION
There is no sound output from DJ speaker.	Another input source is selected.	Select an appropriate input source.
	The mute function is activated.	Cancel the mute function.
	The volume of DJ speaker or TV/other device is adjusted too low.	Increase the volume level on DJ speaker or by remote control or on TV.
	The power cable of the unit is not connected properly.	Make sure that the power cable of the unit is connected to an AC wall outlet securely.
	Input jacks on a playback device are connected.	Connect the input jack on the DJ speaker and the output jack on the playback device.
	Signals that the DJ speaker cannot playback when being input.	When DJ speaker and TV or other devices are connected by an audio cable through TV (ARC) port output, Select the correct audio input and output. Make sure the digital audio output setting on the playback device to Dolby or Auto mode. Since the output format of our DJ speaker is Dolby or Auto mode, if it is used, the decoding format of TV or other devices will be adjusted to Dolby or Auto mode state.
The sound is distorted or echoed.	TV volume is not muted.	If you play audio from TV through the DJ speaker, make sure that the TV is muted.
The volume decreases when the unit is turned on.	The automatic volume adjustment function is activated. To prevent excessive loudness, the unit automatically controls its volume within a certain level when the unit is turned on.	Turn up the volume as required.
Noise is heard.	The DJ speaker is too close to another digital or high-frequency device.	Move those devices away from the DJ speaker.
The unit cannot be operated by using the remote control.	The unit is out of the operating range.	Use the remote control within the operating range.
	The batteries are weak.	Replace with new batteries.
	The remote control sensor of the DJ speaker is exposed to direct sunlight or strong lighting.	Adjust the lighting angle or reposition the DJ speaker. Make sure our product cannot be used in sunlight.
The TV cannot be operated by using the TV's remote control.	The unit is blocking the TV's remote control sensor.	Position the unit so that it does not obstruct the TV's remote control sensor.
A device cannot connect the DJ speaker or the unit cannot be connected to a BT device.	BT function of the device is not activated, not paired or connected correctly.	Restart the DJ speaker and try pairing again. You have not enabled the BT function of the device; see the user manual of the device on how to enable the function and correctly connected the device. The DJ speaker is already connected with another BT device. Disconnect the connected device, and then try again.
	BT is not selected as the input source.	Select BT as the input source.
	The unit is connected to a different BT device.	Un-pair the BT device that is currently connected and pair with the desired BT device.
	The unit is too far away from the BT device.	Move the BT device closer to this unit.
	A device emitting electromagnetic waves (such as a microwave oven, a wireless device and so on) may be placed nearby.	Do not use this unit near devices that emit electromagnetic waves.
	The BT device that you are using may not support the protocol.	Use a BT device that supports the protocol.
	The connection profile registered in the BT device may not be functioning correctly for some reason.	Delete the connection profile in the BT device and then connect the BT device to this unit.
Sound quality of audio play from a connected BT device is poor and connection is not stable.	The BT reception is poor.	Move the device closer to the DJ speaker, or remove any obstacle between the device and the DJ speaker.
No sound can be heard or sound breaks (BT mode)	The volume on the BT device may be too low.	Raise the volume on the BT device.
	BT is not selected as the input source.	Select the BT as the input source.
	Playback on the device has not been performed.	Perform playback on the device.
	The sound output on the BT device may not be set to this unit.	Select this unit as the output device on the BT device.
	The connection to the BT device was cut off.	Connect with the BT device one more time.
	The unit may be too far away from the BT device.	Move the BT device near this unit.

PROBLEM/TROUBLE	POSSIBLE CAUSE	SOLUTION
	A device emitting electromagnetic waves (such as a microwave oven, a wireless device and so on) may be placed nearby.	Do not use this unit near device that emit electromagnetic waves.
There is no sound from DJ speaker - TV (ARC) Mode	Incorrect ARC cable is used causing no signal to be sent to DJ speaker. Incorrect input mode is selected.	1.Make sure that the user connected TV and DJ speaker by a 19-core HD ARC cable. 2.The DJ speaker and TV are connected through TV (ARC) port output; make sure that the TV is ARC compliant. 3.Set the TV to TV ARC (CEC). Set the audio output mode of TV to Dolby or Auto mode. (Or refer to your TV user manual)
There is no sound from DJ speaker (USB mode)	USB file type is not support & DJ speaker doesn't switch to USB input mode automatically when USB is inserted.	Make sure that USB flash drive contains MP3/FLAC files because other file types are not supported. Switch the input mode once again, then playback again.

ISO 9001:2015 Certified Company
www.zebronics.com

