



Portable BT Speaker

ZEB VITA202



User Manual

www.zebronics.com

Thank you for purchasing the **ZEB-VITA 202** Portable BT Speaker. Please read the user manual carefully before usage & save it for future reference.

Note:

- Avoid the usage of this product at high-temperature and high-humidity environments.
- Avoid the self-disassembling of the product or it will result in voiding the Product's warranty.
- Turn off the speaker when it is not in use.

To know more about Terms and conditions for warranty policy, please visit :

<https://zebronics.com/pages/warranty-policy>

Features:

- BT v5.3 | AUX | USB | mSD
- Upto 15h* backup
- Call Function
- TWS Function
- Dedicated Volume Knob
- Dual Passive Radiator
- Type C Charging
- 16W RMS Output
- 8 RGB Modes

Specifications:

Output Power (RMS)	: 16W
BT Version	: v5.3
Driver Size	: 52mm x 2
Speaker Impedance	: 4Ω
Frequency Response	: 100Hz-18kHz
S/N Ratio	: ≥70dB
Max Supported	
USB/mSD memory size	: 32GB
Supported Audio formats	: MP3
Charging time	: 3h
Playback time	: 15h*
Product Dimension	
(WxD xH)	: 43 x 8.5 x 5.1 cm
Net. Weight	: 650g

** at 50% Volume (LED off)*

Package Contents:

Speaker	: 1 U
Charging cable	: 1 U
QR Code Guide	: 1 U

Port & Button Description:

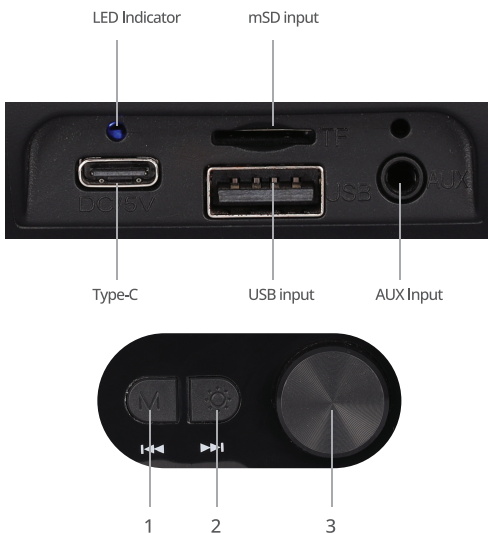

1. Mode / Previous Track

- Short press the button to Switch between modes.
- Long Press the button to move to Previous track.

2. LED / Next Track

- Short press the button to change the LED modes.
- Long Press the button to move to Next Track.

3. Multifunction Knob

- Long Press the Knob to Power ON/OFF the Speaker.

- Turn the Knob Right to Increase the volume.

- Turn the Knob Left to Decrease the volume.

Note: The Volume Level will be indicated in the LED.

Botton Function:

Power On/off:

- Long Press the Control Knob to turn the Speaker ON/OFF.

Bluetooth:

- Once the speaker is on, please make sure that speaker is in BT mode.

- Now, search for nearby BT Device in your mobile and tap on the BT Name **ZEB- VITA 202** to connect.

Instructions for Use :

BT Mode:

Switch on the BT on your mobile phone or other source device and search for BT name **"ZEB- VITA 202"** and tap to connect your source device with speaker.

TWS (True Wireless Stereo) Function :

- Keep both speakers in BT discoverable mode.
- Double press the MF knob on either of the speakers for it to enable the TWS Mode.
- After a few seconds you will hear a notification tone on both the speakers once both are successfully paired via TWS.
- Now turn ON the phone's BT in the settings and search for "**ZEB- VITA 202**" and tap on it to pair with it.
- If you would like to disconnect the two speaker from TWS, double press Mode button.

Note: Requires two speakers for TWS feature

Micro SD / USB mode :

Insert the Micro SD card / USB drive into the respective ports of ZEB- VITA 202 and the speaker would automatically start playing the MP3 files from the Micro SD card/USB drive.

Charging the Speaker :

1. Connect the Type-C - USB charging cable to the Type-C charging port of the speaker and insert the other end into a USB Power source/mobile adapter.

2. Red LED glows constant indicating the speaker's battery is charging. The Red LED will turn off once it is fully charged.