



# Soundbar

## NEB JUKE BAR

# 4101



## User Manual

[www.zebronics.com](http://www.zebronics.com)

## Important Safety Instruction

Thank you for purchasing the **ZEB-JUKE BAR 4101** Soundbar. Please read this user manual carefully and keep for future reference.

### Warning

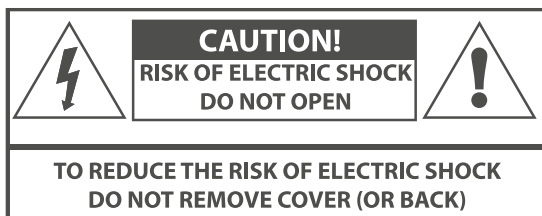

### Caution:

- To reduce the risk of electric shock, do not dismantle the product and do not expose the apparatus to rain or moisture. No user-serviceable parts inside.
- Refer servicing to qualified personnel only.



The lightning flash within an equilateral triangle is intended to alert you to the presence of uninsulated dangerous voltage within the product's enclosure that may be of sufficient magnitude to constitute an electric shock to a person or persons.



Important! This symbol alerts you to read and observe important warnings and instructions on the unit or in this manual.

**Notice:**

1. To prevent possible hearing damage, do not listen at high volume levels for long time periods or a sudden high volume level.
2. Never use the device unsupervised! Switch off the device whenever you are not using it, even if not using it only for a short while.
3. The appliance is not intended to be operated by means of an external timer or separate remote control system.
4. If the supply cord is damaged, it must be replaced by the manufacturer, its service agent or similarly qualified persons in order to avoid a hazard.



5. Before operating this system, check the voltage of this system to see if it is identical to the voltage of your local power supply.
6. The unit should not be impeded by covering the ventilation opening with items such as newspaper, table-cloths, curtains etc. Make sure that there are at least 20 cm of space above and at least 5 cm of space on each side of the unit.
7. The apparatus must not be exposed to dripping or splashing liquid, no objects filled with liquids such as vases, should be placed on the apparatus.
8. To prevent fire or shock hazard, do not expose this equipment to direct heat, rain, moisture or dust.
9. Do not position this unit near any water sources e.g. taps, bathtubs, washing machines or swimming pools. Ensure that you place the unit on a dry, stable surface.
10. Do not place this unit close to a strong magnetic field.
11. Do not place the unit on a amplifier or receiver.
12. Do not place this unit in a damp area as the moisture will affect the life of electric components.
13. Do not attempt to clean the unit with chemical solvents as this might damage the finish. Wipe with a clean, dry or slightly damp cloth.



14. When removing the power plug from the wall outlet, always pull directly on the plug, never pull on the cord.

15. Depending on the electromagnetic waves used by a television broadcast, if a TV is turned on near this unit while it is also on, lines might appear on the LED TV. Neither this unit nor the TV is malfunctioning. If you see such lines, keep this unit well away from the TV set.

16. The mains plug is used to disconnect the device, the disconnected device should remain readily operable.

**Power Source:**

This soundbar is designed to operate in DC 24V  $\approx$  1.5A.

## **Preparation for Use**

### **Unpacking and Set Up**

- Remove the Sound bar from the carton and remove all packing material from the Sound bar. Save the packing material, if possible, in case the Sound bar ever needs to be serviced or transported.
- The original carton and packing material is the only safe way to pack your Sound bar to protect it from damage in transit.
- Remove any descriptive labels or stickers on the front or top of the cabinet. Do not remove any labels or stickers from the back or bottom of the soundbar.
- Place your Sound bar on a level surface such as a table, desk or shelf, convenient to an AC outlet, out of direct sunlight, and away from sources of excess heat, dirt, dust, moisture, humidity, or vibration.
- Unwind the Line cord connecting the AC adapter and extend it to its full length.

### **Protect Your Furniture**

This model is equipped with non-skid rubber 'feet' to prevent the product from moving when you operate the controls. These 'feet' are made from non-migrating rubber material specially formulated to avoid leaving any marks or stains on your furniture. However certain types of oil based furniture

polishes, wood preservatives, or cleaning sprays may cause the rubber 'feet' to soften, and leave marks or a rubber residue on the furniture. To prevent any damage to your furniture we strongly recommend that you purchase small self-adhesive felt pads, available at hardware stores and home improvement center everywhere, and apply these pads to the bottom of the rubber 'feet' before you place the unit.



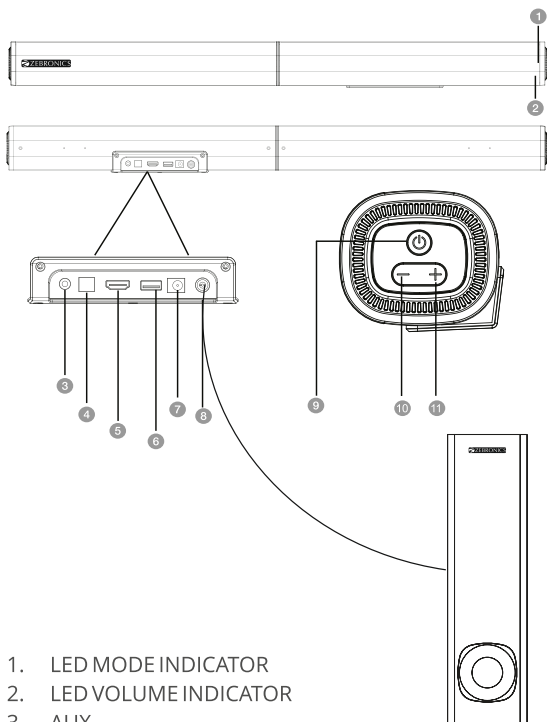

# Product Representation

## Sound Bar & Sub-Woofer

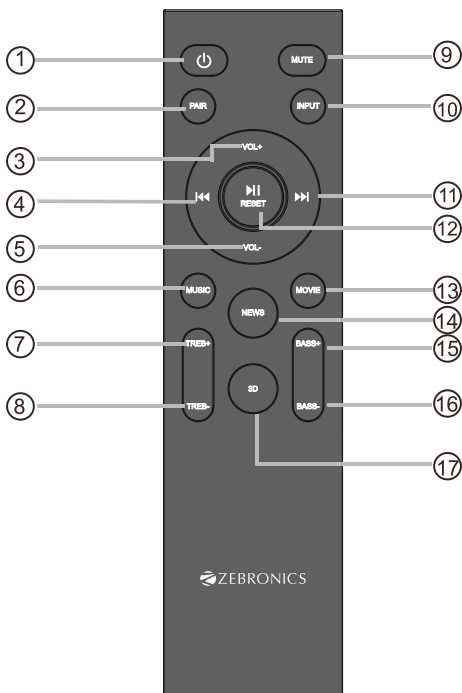

# Remote Control



1.  : Standby mode for power on/off.
2. Pair : Connect or Disconnect to the Pairing Device.  
(Press the Button more than 2 Seconds)
3. VOL+ : Master Volume Increase.
4.  : Previous Track  
(Only work under USB & BT Mode).
5. VOL- : Master Volume Decrease.
6. MUSIC : Select the Music EQ effect.
7. TREB+ : Treble Volume Increase.
8. TREB- : Treble Volume Decrease.
9. MUTE : Mute Volume.
10. INPUT : Input mode(AUX/USB/HDMI(ARC)/OPT/BT)
11.  : Next Track  
(Only work under USB & BT mode).
12.  / RESET  
Play/Pause : Play / Pause for Current Track  
(Only work under USB and BT mode).  
Reset : Press and hold the button more than 2 sec. to Set all functions to manufacturer defaults.
13. MOVIE : Select the Movie EQ effect.
14. NEWS : Select the News EQ effect.
15. BASS+ : Bass Increase.
16. BASS- : Bass Decrease.
17. 3D : Select the 3D EQ effect.

## **Operating Range of the Remote Control**

1. When the unit is mounted on a wall, point the remote control at the remote control sensor on the bellowed panel. The provided Remote Control allows the unit to be operated from a distance.
2. Even if the Remote Control is operated within the effective range 26.2 feet (8m), remote control operation may be impossible if there are any obstacles between the unit and the remote control.
3. If the Remote Control is operated near other products which generate infrared rays, or if other remote control device using infrared rays are used near the unit, it may operate incorrectly. Conversely, the other products may operate incorrectly.

## Positioning the Sound Bar

### Table Placement

Place the sound bar horizontally on a solid surface such as a TV unit or shelves and align it centrally with the TV screen.

For best sound output and good airflow around the soundbar, place your soundbar as shown below.

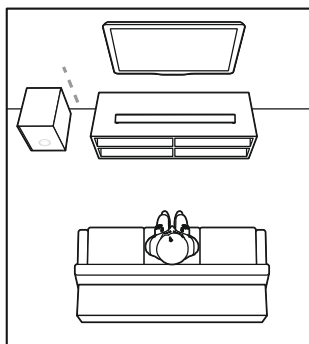

### Follow below steps to mount the sound bar on the wall

Step1 : Paste 2 pieces of EVA foam (with holes) on the two wall brackets aligning at the hole position of wall brackets.

Step2 : Remove 4 screws from the rear housing of sound bar, then insert the 4 screws over the wall bracket screw holes aligning (on the side of EVA foam pasted), and then fasten the screws again.



Step3 : According to the two hanging wall positions on the rear of soundbar, calibrate and mark the two hanging brackets hole position on the wall. Then drill two holes on the wall, firstly insert two expansion plastic screws on the wall, then fasten the hanging screws into expansion screw holes.

Step4 : Then Paste the 2 pieces of EVA foam (without holes) on the two wall brackets downward. Then place the hollow cross in the center of the bracket against the screws on the wall and hang the sound bar on the wall finally.

**Note :**

1. Wipe off any dirt such as oil on the adhesive surface of the sound bar before adhering.
2. Make sure that the adhesive is securely attached.
3. When peeling off the release paper of the double-sided tape, be careful not to get dirt such as finger oil on the adhesive surface.
4. Be careful of deterioration of double-sided tape due to storage conditions.

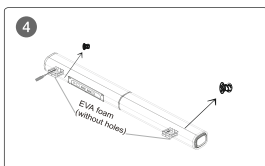
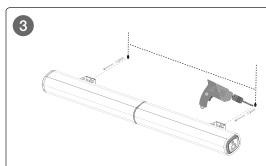
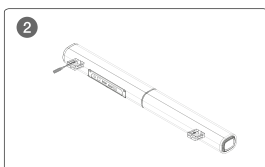
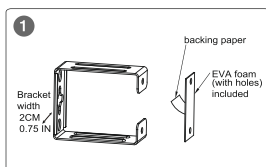

## Mount the unit on a wall

### CAUTION



1. When mounting the soundbar on a wall, all installation must be performed in right way. The customer must never attempt to install it without authorization. Improper or inadequate installation may cause the sound bar to fall so as to result in personal injury.
2. To prevent the sound bar from falling, attach it to a wall constructed of drywall (plasterboard)
3. Make sure that commercially available screws are used so that can support the weight of the installation.
4. Fix the cables in place where they will not become loose. If your foot or hand accidentally gets caught on a loose cable, the sound bar may fall.
5. Do not lean on the sound bar or apply excessive force to the top of the sound bar, which may cause it to fall.

### Soundbar Assemble Details

1. Please connect the left audio cable with the right audio input.

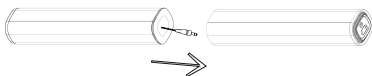

2. Hold the convex interface of the soundbar with one hand and turn the other interface to the right until locks securely.

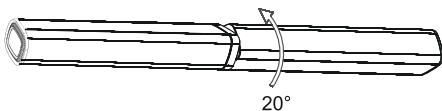

3. Place the soundbar on a furniture. It is ready to be used.

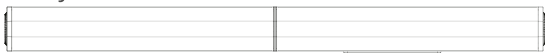

## OPERATE INSTRUCTIONS

### Setting the Soundbar

1. Plug the power cord in and the LED will light up.
2. Input mode can be changed by pressing the STANDBY/INPUT on soundbar or by using the INPUT button on remote. BT / Optical / USB / HDMI (ARC) / AUX connection mode can be switched; The mode indicator can change into 5 different colors, representing different states:

Blue : BT Pairing Mode

Green : AUX Mode

Orange : Optical mode

Pink : USB Mode

Cyan : HDMI (ARC) Mode

Red : Standby Mode

3. When mode indicator light on, press Standby or Power button to turn off; when the indicator light off.
4. Volume value: the volume value is 00-32, and the factory set value is "10". It has last volume memory function. When pressing the Vol- or Vol+ on the soundbar or remote, the volume indicator will be flickering and scrolling.
5. When pressing the EQ mode on the remote, the mode indicator will be flickering once.

## Powering On/Off

1. Plug the adapter cord of the soundbar into a wall outlet, it will automatically enter standby mode; The LED indicator will turn on red.
2. Press the STANDBY button on the soundbar or POWER button on the remote control to turn the soundbar on. Make your selection of the desired input modes by pressing the INPUT button on the remote control or the standby button on the soundbar.
3. To turn off, press and hold the STANDBY button or POWER button on remote control for about 2 seconds, the soundbar will enter standby mode and LED indicator will turn on red, and then unplug it from the wall outlet.

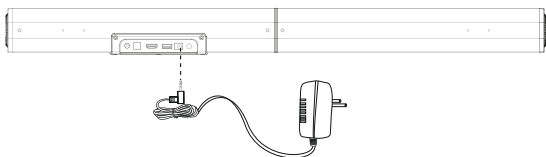

## Using the Soundbar

### Playing Audio via BT Connection

1. Use either Power/standby button on the SoundBar or the "INPUT" button on the remote to activate BT mode. A Blue LED indicator will indicate that BT mode has been selected.
2. Turn on Bluetooth of your device, search for **"ZEB-JUKE BAR 4101"** on your Bluetooth list, and then select Bluetooth connection.
3. When successfully paired, you will hear a tone and the blue LED mode indicator will stay on.
4. Use the volume buttons on the sound bar or on the remote controller to adjust the volume.
5. The remote controller includes Bluetooth mode playback controls. Press and hold PAIR button on the remote controller more than two seconds to disconnect paired Bluetooth device or connect back last disconnected Bluetooth device.
6. If you wish, you can change the audio settings by using the relevant buttons on the remote controller.

#### Notes:

1. *In Bluetooth mode, the remote can control music play/pause or select previous or next track. PREV / NEXT / PLAY & PAUSE button only work in Bluetooth mode; they have no function in other modes.*
2. *The above pairing procedure doesn't need to be repeated with the same connected device once paired.*

3. If the connected device is switched off or manually disconnected, the sound bar will automatically enter pairing mode.

4. If the connected device is moved away from wireless range (up to 10 meters) of the sound bar, then it will get disconnected, and it will successfully connect to the device once you re-enter Bluetooth range. To connect to other devices, repeat the above pairing steps.

5. If a Bluetooth device has been connected before, the sound bar will connect to the last connected device. Unpair this connection to connect a new device.



## Playing Audio via USB Port

When the USB flash drive is plugged in, the sound bar automatically switches to USB input mode. A Pink LED indicator will indicate that USB mode has been selected. This mode cannot be selected on the sound bar or remote control unless it is connected to a USB flash drive.

1. Ensure that your USB flash drive contains MP3 audio files (other file types not supported)
2. Connect the USB flash drive to the USB port on the sound bar (or your own USB extension cable connected to the USB port); music will automatically play
3. The remote control includes USB input mode playback controls

## Audio input (AUX) Connection

1. Use a 3.5mm to 3.5mm audio cable to connect the PC, tablet, smartphone, TV's headphone socket to the AUX socket on the soundbar. Use a RCA to 3.5mm audio cable to connect the Blue Ray DVD Player / TV's audio output sockets to the AUX socket on the soundbar.
2. Use either the POWER/STANDBY button on the SoundBar or the "INPUT" button on the remote to activate AUX mode. A green LED indicator will indicate that AUX mode has been selected.
3. Playback functions (play/pause, tracks, pair) cannot be adjusted through the SoundBar remote when in AUX mode. Others playback functions can be controlled from the buttons on the SoundBar. In this mode, playback can only be controlled on your connected device

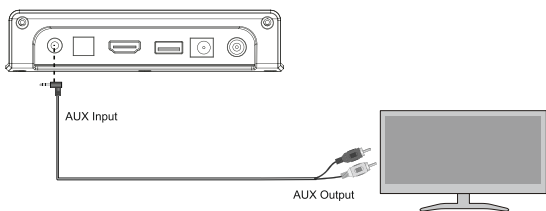

## HDMI (ARC) Mode

1. The sound bar supports HDMI(ARC) with audio return channel (ARC). You can hear the TV audio through your sound bar by using a

single HDMI(ARC) cable. But on condition that your TV is ARC compliant.

2. Using a high speed HDMI(ARC) cable, connect the HDMI(ARC) connector on the sound bar to the HDMI(ARC) connector on the TV. The HDMI(ARC) connector on the TV might be labeled differently. For details, see the user manual of your TV.

3. When HDMI(ARC) is connected, TV sound setting in "sound output" mode should be set as <external PCM Stereo>, in addition, digital audio output mode should be set as <automatic> or <decoded output as PCM state>. When the HDMI(ARC) cable is connected, the TV digital audio output is set as PCM format. Then start playing music on the TV.

4. Press "INPUT" button on the remote control or "STANDBY" button on sound bar to select HDMI (ARC) mode and the LED mode indicator will turn on Cyan. Different TV might be different setting, please refer to your TV User Manual.

5. Use the volume buttons to adjust the volume to your requirements.

6. You can also change the audio settings by using the relevant buttons on the remote control.

**Note:**

1. When connecting a device such as a TV/Set-top box/DVD/ game console with HDMI(ARC) cable, set the



audio output mode of the device to PCM mode <digital HDMI (ARC) output>.

2. The TV is connected to a HDMI(ARC) port with sound bar. Different TVs might have different setup menus, but the operation approach is the same.

3. If needs to connect set-up box meanwhile, please firstly connect the HDMI(ARC) connector and paired to the sound bar. Then connect the set-top box.

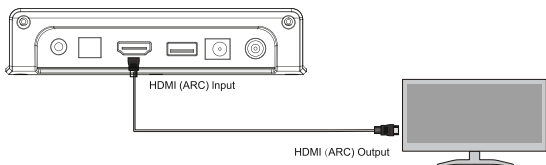

## Optical Mode

Remove the cap of optical cable (keep the cap for the future use); check the direction of the plug. Connect the sound bar and TV with the optical cable.

Use this mode to play music from a TV with optical digital output on the sound bar. In TV sound settings, select the sound bar optical connection (output for audio). When the optical cable is connected, the TV audio output is set to PCM format.

The TV must have an optical digital output. Use the supplied optical cable to make the connection as follows:

1. Connect the optical cable to the optical digital output of your TV.

2. Connect the optical cable to the optical digital input of your sound bar.

3. Switch on the TV set and the sound bar. Set the connected TV to "PCM Stereo". Set the audio output mode as <automatic> or <decoded output as PCM state>.
4. Start playing on the TV.
5. Press "INPUT" button on the remote control or "STANDBY" button on the sound bar to select OPTICAL mode and the LED mode indicator will turn on orange.
6. Use the volume buttons to adjust the volume to your requirements.
7. You can also change the audio settings by using the relevant buttons on the remote control.

**Note:**

1. When connecting a device such as a TV/Set-top box/ DVD/ game console with optical cable, set the audio output mode of the device to PCM mode (digital optical output).
2. Do not bend the optical cable, otherwise the cable inside will be damaged.

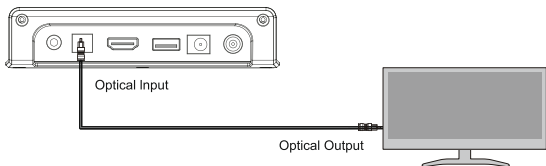

# Troubleshooting

PROBLEM/TROUBLE	POSSIBLE CAUSE	SOLUTION
There is no sound output from sound bar.	Another input source is selected.	Select an appropriate input source.
	The mute function is activated.	Cancel the mute function.
	The volume of sound bar or TV/other device is adjusted too low.	Increase the volume level on sound bar or by remote control or on TV.
	The power cable of the unit is not connected properly.	Make sure that the power cable of the unit is connected to an AC wall outlet securely.
	Input jacks on a playback device are connected.	Connect the input jack on the sound bar and the output jack on the playback device.
	Signals that the sound bar cannot playback when being input.	When sound bar and TV or other devices are connected by an audio cable through TV (ARC) port output, Select the correct audio input and output. Make sure the digital audio output setting on the playback device to PCM format. Since the output format of our sound bar is PCM, if it is used, the decoding format of TV or other devices will be adjusted to PCM state.
The sound is distorted or echoed.	TV volume is not muted.	If you play audio from TV through the sound bar, make sure that the TV is muted.
The volume decreases when the unit is turned on.	The automatic volume adjustment function is activated. To prevent excessive loudness, the unit automatically controls its volume within a certain level when the unit is turned on.	Turn up the volume as required.
Noise is heard.	The sound bar is too close to another digital or high-frequency device.	Move those devices away from the sound bar.
The unit cannot be operated by using the remote control.	The unit is out of the operating range.	Use the remote control within the operating range.
	The batteries are weak.	Replace with new batteries.
	The remote control sensor of the sound bar is exposed to direct sunlight or strong lighting.	Adjust the lighting angle or reposition the sound bar. Make sure our product cannot be used in sunlight.
The TV cannot be operated by using the TV's remote control.	The unit is blocking the TV's remote control sensor.	Position the unit so that it does not obstruct the TV's remote control sensor.
A device cannot connect the sound bar or the unit cannot be connected to a Bluetooth device.	Bluetooth function of the device is not activated, not paired or connected correctly.	Restart the sound bar and try pairing again. You have not enabled the Bluetooth function of the device; see the user manual of the device on how to enable the function and correctly connected the device. The sound bar is already connected with another Bluetooth device. Disconnect the connected device, and then try again.
	Bluetooth is not selected as the input source.	Select Bluetooth as the input source.
	The unit is connected to a different Bluetooth device.	Un-pair the Bluetooth device that is currently connected and pair with the desired Bluetooth device.
	The unit is too far away from the Bluetooth device.	Move the Bluetooth device closer to this unit.
	A device emitting electromagnetic waves (such as a microwave oven, a wireless device and so on) may be placed nearby.	Do not use this unit near devices that emit electromagnetic waves.
	The Bluetooth device that you are using may not support the protocol.	Use a Bluetooth device that supports the protocol.
	The connection profile registered in the Bluetooth device may not be functioning correctly for some reason.	Delete the connection profile in the Bluetooth device and then connect the Bluetooth device to this unit.
Sound quality of audio play from a connected Bluetooth device is poor and connection is not stable.	The Bluetooth reception is poor.	Move the device closer to the sound bar, or remove any obstacle between the device and the sound bar.
No sound can be heard or sound breaks (Bluetooth mode)	The volume on the Bluetooth device may be too low.	Raise the volume on the Bluetooth device.
	Bluetooth is not selected as the input source.	Select the Bluetooth as the input source.
	Playback on the device has not been performed.	Perform playback on the device.
	The sound output on the Bluetooth device may not be set to this unit.	Select this unit as the output device on the Bluetooth device.
	The connection to the Bluetooth device was cut off.	Connect with the Bluetooth device one more time.
	The unit may be too far away from the Bluetooth device.	Move the Bluetooth device near this unit.

PROBLEM/TROUBLE	POSSIBLE CAUSE	SOLUTION
	A device emitting electromagnetic waves (such as a microwave oven, a wireless device and so on) may be placed nearby.	Do not use this unit near device that emit electromagnetic waves.
There is no sound from sound bar - HDMI TV (ARC) Mode	Incorrect HDMI cable is used causing no signal to be sent to soundbar. Incorrect input mode is selected.	1. Make sure that the user connected TV and sound bar by a 19-core HD ARC cable. 2. The sound bar and TV are connected through TV (ARC) port output; make sure that the TV is ARC compliant. 3. Set the TV to HDMI ARC (CEC). Set the audio output mode of TV to PCM format. (Or refer to your TV user manual)
There is no sound from sound bar (OPTICAL Mode)	OPTICAL cable might be damaged and no signal is received by the soundbar due to a failed connection and incorrect operation mode selected.	1. Replace the OPTICAL cable with a new one to connect. 2. Set your TV audio output to PCM format. (Pls refer to your TV user manual)
Disconnected between subwoofer and sound bar	Connection is not correct between subwoofer and sound bar	1. Turn off sound bar and subwoofer by removing the adapter from the socket. 2. Make sure that sound bar and subwoofer are connected to the electricity power at the same time, and switch on sound bar and subwoofer again. 3. Press and hold the subwoofer's rear plate WPS button to reset the connection, so that the sound bar and subwoofer can be reconnected again.

## Features:

Wireless BT/USB/AUX/Optical IN/HDMI(ARC)

13.33cm Subwoofer

Remote control

LED Indicator

Wall Mountable

Volume/Media Control

External Power adapter

Virtual 5.1

## Specifications

Output Power (RMS)

Subwoofer : 60W

Soundbar : 25W x 2

Total : 110W

Driver Size

Subwoofer : 13.33 cm x 1

Soundbar : (5 cm x 9 cm) x 2

Impedance

Subwoofer : 6Ω

Soundbar : 4Ω

Frequency Response	: 55Hz-20kHz
S/N Ratio	: $\geq 70$ dB
Separation	: $\geq 32$ dB
File format support	: MP3 (USB)
Line input	: 3.5mm, Optical IN, HDMI (ARC)
Max supported memory size (USB)	: 32 GB
BT name	: ZEB-JUKE BAR 4101
BT version	: 5.0
Product Dimension (W x D x H)	
Subwoofer	: 13.2 x 21 x 36 cm
Sound bar	: 75 x 7.3 x 6.2 cm
Net. Weight	
Subwoofer	: 3 kg
Soundbar	: 1.25 kg
Total	: 4.25 kg

**ISO 9001:2015 Certified Company**  
**[www.zebronics.com](http://www.zebronics.com)**

