

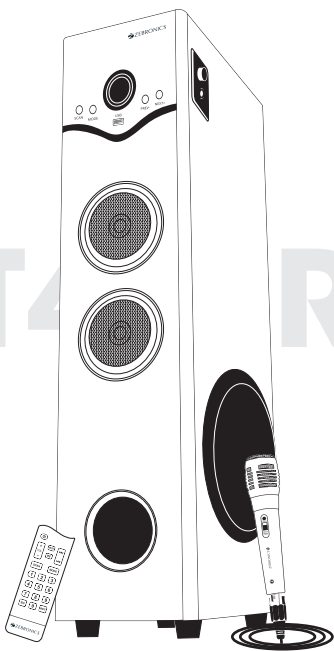

Tower Speaker

ZEB **BT460RUF**



**User Manual**

[www.zebronics.com](http://www.zebronics.com)

Dear Customer,

Thank you for purchasing the **ZEB-BT460RUF** Speaker. Please read the user manual carefully before usage & save it for future reference.

**Note:**

- Avoid the usage of this speaker at the high temperature and high humidity environment.
- Avoid the self-disassembly of the product as it results in the failure of Warranty.

**Features**

Wireless BT/USB/FM/AUX/MIC Input

LED display

13.33cm Subwoofer

Remote control

Karaoke

Wired Mic

**Specification**

Output power (RMS) : 50W

Driver size

Subwoofer : 13.33cm

Full range : 7.62cm x 2

Impedance

Subwoofer : 8Ω

Full range : 4Ω

Frequency response : 40Hz- 20kHz

S/N Ratio	: ≥70dB
File format support	: Mp3 (USB)
Line input	: 2ch RCA
Max. Supported USB memory size	: 32GB
FM Frequency scan range	: 87.5MHz - 108MHz
BT Name	: Zebronics
BT Version	: 4.2
Product dimension	: 150 x 255 x 620 mm (W x D x H)
Net. Weight	: 5.07kg

### **Package contents**

Speaker	: 1 U
Remote control	: 1 U
Input cable	: 1 U
Wired Microphone	: 1 U
QR Code Guide	: 1 U

## Product description:

### Front panel

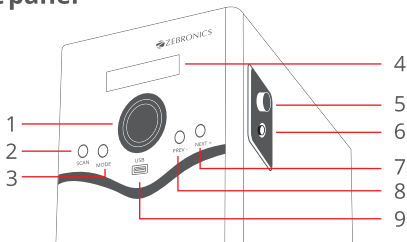

- |   |                      |
|---|----------------------|
| 1. Volume control Knob                      | 6. Mic. Input port   |
| 2. FM-Scan (Long Press)<br>Play-Pause/ Mute | 7. Next+/Fine Tune + |
| 3. Input mode                               | 8. Prev-/Fine Tune - |
| 4. LED Display                              | 9. USB Port          |
| 5. Mic. Volume control Knob                 |                      |

### Back Panel

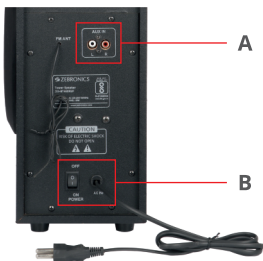

#### **A : Audio Input (AUX) - Stereo Input**

These jacks are used to receive the Stereo signal from a CD/VCD/DVD (2CH) player.

#### **B : AC Power - Power ON and OFF**

This turns the power of the speaker ON/OFF.  
AC/IN (~230V 50/60Hz) AC Power Cord.

## Remote control

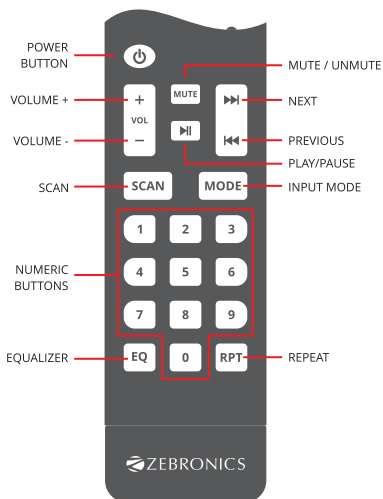

**Power:** Standby ON/OFF

**Numeric Pad (0-9) :** To select particular track from USB drive directly or to enter FM Channel frequency directly

**Vol+:** To increase the volume

**Prev:** To select the previous tracks in BT/USB or to Tune in FM mode

**Vol-:** To decrease the volume

**RPT:** To Switch between available repeat modes

**Scan:** To scan all FM channels available

**Mode:** Mode Selection (BT/AUX/USB/FM)

**EQ :** Short press for Equalizer/long press for (Mic Echo, Mic Volume, Mic Priority)

**Play/Pause** To Play / Pause the current track. To switch next channel in FM mode

**Next :** To select the next tracks in BT/USB or to Tune in FM Mode

## Instructions for Use:

### Button functions

1. Press the **“Mode”** Button to change the input mode (BT/AUX/USB/FM) of the speaker.
2. Short press the **“Next / FM Tune+”** Button to change the Next track or Channel when in BT/USB mode or FM mode respectively.
3. Short press the **“Prev / FM Tune-”** Button to change the Previous track or channel when in BT/USB mode or FM mode respectively.
4. Short press the **“Scan”** Button to scan all FM channels available.

### General Instructions

#### BT Mode:

Power ON the speaker, press **“Mode”** button to switch to BT Mode. Switch ON BT on your phone or tablet and search for nearby BT devices, Search for the BT name **“Zebronics”** and tap to connect it.

#### USB Mode:

The speaker automatically switches to USB input mode with the LED display when a USB flash drive is inserted (This mode isn't selectable on the speaker or remote control unless a USB flash drive is connected). Ensure that your USB flash drive contains MP3 audio files (other file types not supported).

## **FM Radio:**

Switch the speaker to FM mode. In FM mode, use the **Scan** button in the control panel or remote to scan for the available FM channels. Once the scanning is done, the scanned channels will begin to play. Use Next/Previous button on the control panel can be used to change the FM Channels.

## **AUX-IN:**

The speaker can be connected to an audio device using an RCA to 3.5mm Cable. Connect the one end of the cable to the speaker and the other end to an audio source. The tracks from the audio source can be heard through the speaker.

## **Instructions for Mic Settings:**

Press & Hold the EQ Button on the remote control to enter Mic settings.

In Mic settings, the following setup will appear on the LED display (Press & hold again to switch between the Mic settings).

To adjust Mic Echo, Press & hold EQ it'll direct you to ECHO volume "E", now short press 'Vol+' or 'Vol-' Button on remote control.

To adjust Mic volume, Press & Hold EQ Twice it'll direct you to Mic volume "M", now short press 'Vol+' or 'Vol-' button on remote control and also you can use Mic volume control Knob.

To change the Mic priority, Press & hold EQ thrice it'll direct you to PRIORITY setting "C", now short press 'Vol+' or 'Vol-' button on remote to set the MIC priority.

**ISO 9001:2015 Certified Company**  
**[www.zebronics.com](http://www.zebronics.com)**

