

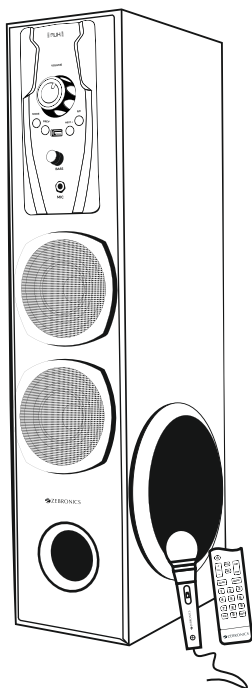

MB Tower Speaker ZEB **LEGEND**



User Manual

www.zebronics.com

Dear Customer,

Thank you for purchasing our ZEB-LEGEND Mono Tower Speaker. Please read the user manual carefully and save this manual for future reference.

Note:

- Avoid the usage of the product at high temperature and high humidity environment.
- Avoid the self- disassembly of the product as it results in voiding your warranty.
- Turn off the speaker when the speaker is not in use.
- To know more about Terms and conditions for warranty policy, please visit <https://zebronics.com/pages/warranty-policy>

Features

Wireless BT/USB/ FM /AUX/MIC Input

LED display

13.33cm Subwoofer

Remote control

Karaoke

6.3mm Microphone Input

Bass & Volume Control Knob

Specification

Output Power (RMS) : 80W

Driver Size

Subwoofer : 13.33cm

Mid range : 10.16 cm x 2

Impedance	
Subwoofer	: 8Ω
Mid range	: 4Ω
Frequency response	: 20Hz – 20 kHz
S/N Ratio	: ≥70dB
Separation	: ≥75dB
File format support	: Mp3
Line input	: 2ch RCA
Max. supported USB memory size	: 32GB (Max)
FM frequency scan range	: 87.5MHz - 108MHz
BT Name	: ZEB-LEGEND
BT version	: v5.0
Product Dimension (W x D x H)	: 16.2 x 25 x 66.7 cm
Net. Weight	: 6.1kg

Package Content

Speaker	: 1 U
Remote	: 1 U
Input Cable	: 1 U
Wired Microphone	: 1 U
QR Code Guide	: 1 U

Product Description:

Front Panel

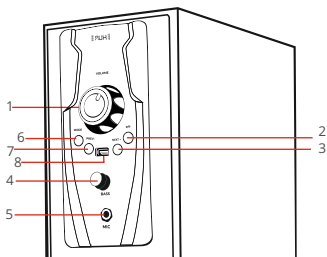

- | | |
|------------------------|---------------|
| 1. Volume Control Knob | 6. Input Mode |
| 2. Play/Pause | 7. Prev- |
| 3. Next + | 8. USB Port |
| 4. Bass Control Knob | |
| 5. Microphone Input | |

Back Panel

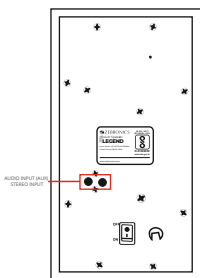

A: AUDIO INPUT (AUX)- STEREO INPUT

- These jacks are used to receive the STEREO signal from a CD/DVD (2CH) Player
- You can also use the included RCA to 3.5mm cable to and connect the other end of the cable to the input audio source

Remote Control

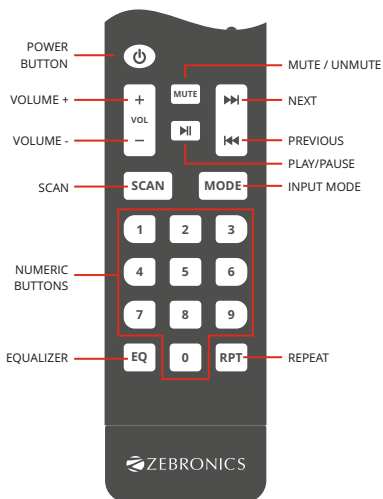

Power : standby ON/OFF

Numeric Pad(0-9) : To select particular track from USB drive directly or to enter FM Channel frequency directly

Vol+ : To increase the volume

Prev : To select the previous tracks in BT/USB or to Tune in FM mode

Vol- : To decrease the volume

RPT : To Switch between available repeat modes

Scan : To scan all FM channels available

Mode : Mode Selection (BT/AUX/USB/FM)

EQ : Short press to control BASS and short Press again to control TREBLE. Long Press to use Equalizer

Play/Pause To Play / Pause the current track. To switch next channel in FM mode

Next : To select the next tracks in BT/USB or to Tune in FM mode

Mute To Mute / Unmute

Instructions for Use:

Button functions

1. Short press the **Mode** button on the integrated control panel or the remote control to change the speaker's input mode (BT, AUX, USB & FM).

2. Short press on the **Next** button to switch to the next song in BT / USB mode or FM mode respectively.

- Long Press to Increase the volume.

3. Short press on the **Prev** button to switch to the previous song in BT / USB mode or FM mode respectively.

- Long Press to Decrease the volume.

4. Short press on the **Play/Pause** button to pause or play the song played in the BT / USB mode or Scan In Fm mode.

5. Adjust the integrated **VOLUME** knob on the front panel of the speaker to increase or decrease the volume of the speaker.

6. Adjust the integrated **BASS** knob on the front panel of the speaker to increase or decrease the Bass of the speaker.

- Toggle the rocker switch on the rear panel of the speaker to Turn on / Turn off the speaker.

General Instructions

BT Mode:

Turn on the speaker and short press “mode button” to switch to BT mode. Now turn your BT on your phone, tablet or computer and click on scan for nearby BT devices. Once the search is completed search for the BT name “**ZEB-LEGEND**” and tap on it to pair with your device.

USB Mode:

The speaker automatically switches to **USB Input Mode** when the USB flash drive is plugged into the USB slot of the speaker.

Note: This mode is not available until USB flash drive is inserted. Also, please make sure that your flash drive has MP3 audio files other audio file formats are not supported.

FM Radio:

Switch to **FM** mode by pressing the mode button in remote, then short press the Play / Pause button to Scan for the available FM channels. Once the scanning process is done, the speaker plays the first scanned FM channel. Now press on the **next / prev** button on the front panel to switch to the previous or next scanned FM channel. Alternatively you can use the remote control to switch the **FM** channel by pressing the Numeric pad of the remote control.

AUX Mode:

The speaker can be connected to an audio device by using the included RCA to 3.5mm cable. Connect the RCA cable according to the color of the connector, and connect the other end of the cable to the input audio source. Now you can play the audio content of the input device, which is directly delivered to the speakers.

INSTRUCTIONS FOR USING THE REMOTE CONTROL'S INTEGRATED MICROPHONE FUNCTION BUTTONS:-

1) Long press EQ button once to Select ECHO
To adjust Echo volume Press Vol + / Vol-

2) Long press EQ button again to Select mic volume

To adjust Mic volume Press Vol + / Vol-

3) Long press EQ button again to Select mic Priority

To adjust Mic Priority Press Vol + / Vol-

Press and hold the EQ button thrice to toggle the microphone priority feature.

To adjust the microphone priority feature press "Vol +" to increase the priority of the microphone output or "Vol -" to decrease the priority of the microphone output.

ISO 9001:2015 Certified Company

www.zebronics.com

