



ZEBRONICS
ALWAYS AHEAD

Uninterruptible Power Supply

ZEB **U725**



User Manual

www.zebronics.com

Dear Customer,

Thank you for purchasing the **ZEB-U725** UPS. Please read the user manual carefully before usage & save it for future reference.

Important Safety Instructions

- The voltages inside UPS may be hazardous. Do not attempt to disassemble the unit. The unit contains no user serviceable parts. Only factory service personnel may perform repairs.
- Internal battery voltage is 12Vdc. sealed, lead-acid, 6 cells battery.
- Connection to any other type of socket other than a two-pole, three-wire grounded socket may result in shock hazard as well as violating to local electrical codes.
- In the event of an emergency, press the OFF button and disconnect the power cord from the AC power supply to properly disable the UPS. Do not allow liquids or any external objects to enter the UPS. Do not place beverages or any other liquid-containing vessels on or near the unit.
- This unit is designed for installation in a controlled environment (temperature controlled, indoor area free of conductive contaminants). Avoid installing the UPS in locations where there is static or flowing water, or excessive humidity.
- Do not plug the UPS input into its own

output.

- Do not attach a power strip or surge suppressor to the UPS.
- Do not connect non-computer-related items, such as medical equipment, life-support equipment, microwave ovens, or vacuum cleaners to UPS.
- To reduce the risk of overheating the UPS, do not cover the UPS cooling vents and avoid exposing the unit to direct sunlight or installing the unit near heat emitting appliances such as air heaters or furnaces.
- Unplug the UPS prior to cleaning and do not use liquid or spray detergent.
- Do not dispose the batteries into fire as they may explode. Do not open or mutilate the battery or batteries. Released electrolyte is harmful to the skin and eyes. It may be toxic.
- A battery can present a risk of electrical shock and high short circuit current. The following precautions should be observed when working on batteries:
 - a) Remove watches, rings, or other metal objects from the hands.
 - b) Use tools with insulated handles.
 - c) Wear rubber gloves and boots.
 - d) Do not lay tools or metal parts on top of batteries.
- Disconnect charging source prior to connecting or disconnecting batteries

terminals.

- Servicing of battery should be performed or supervised by technical and authorized personnel only.
- When replacing battery, replace with the same type of sealed lead-acid battery. The maximum ambient temperature rating is 40°C.

UPS Installation Procedure

- Your new UPS may be used immediately; however recharging the battery for atleast 8hours (no load) is recommended to ensure that the battery maximum charge capacity is achieved. Charge loss may occur during shipping and storage. To recharge the battery, simply leave the unit plugged into an AC outlet. The unit will charge in both the on and off position.
- With the UPS unit off and unplugged, connect the computer, monitor, and any externally powered data storage device (Zip drive, Jazz drive, Tape drive, etc.) into the battery power supplied outlets. DO NOT plug laser printer, copier, space heater, vacuum, paper shredder or other large electrical device into the battery power supplied outlets. The power demands of these devices will overload and possibly damage the unit.
- Plug the UPS into a 2 pole, 3 wire grounded socket (wall outlet). Make sure the

wall branch outlet is protected by a fuse or circuit breaker and does not service equipment with large electrical demands (e.g. air conditioner, refrigerator, copier, etc. Avoid using extension cords.

- Press the power switch to turn the unit ON. The power on indicator light will illuminate and the unit will "beep".
- If an overload is detected, an audible alarm will sound and the unit will emit beep once every 0.5 seconds. To correct this turn the UPS off and unplug atleast one piece of equipment from the battery power supplied outlets. Wait 10 seconds Make sure the fuse is normal and then turns the UPS on.
- To maintain optimal battery charge, leave the UPS plugged into an AC outlet at all times.
- To store your UPS for an extended period, cover it and store with the battery fully charged. Recharge the battery every three months to ensure battery life.

Product Description

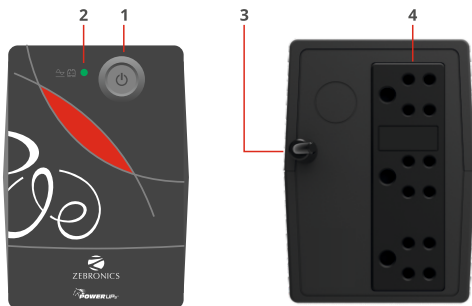

Front Panel

1. Power Switch
2. LED Indicator
 - AC Mode : Green LED Glow
 - Battery Mode : Green LED blinks
 - Fault Mode : Red LED Glow

Back Panel:

3. AC input
4. Output Sockets

Power On/Off (AC mode)

To turn on the UPS unit, press the power switch lightly. To turn off the UPS unit, press the power switch again

Power On/Off (Battery mode)

To start the UPS when AC utility power is not available, simply press the power switch.

LED Indication and Alarm

Condition	Indication	Alarm
Normal	Green LED Glows	----
Battery Discharge	Green LED blinks	Beep once every 10 seconds
Battery Low	Green LED blinks	Beep once every 1 second
Fault		Continuous Beeping

Features

Line interactive UPS

Auto restart while AC is recovering

Double Boost

Automatic Voltage Regulation (AVR)

Wide Input Range

Microcontroller Based

Generator Compatible

No load Auto Shutdown at battery mode*

**Minimum load should be >40W*

Specifications

Capacity	(VA/W)	600VA/360W
Input	Nominal voltage	220-240 VAC
	Voltage range	140-300 VAC
	Frequency	50/60 Hz
	Plug type	3 Pin plug
Output	Voltage range	230VAC±10% (AC mode)
	Voltage range	230VAC±10% (Batt. mode)
	Frequency range	50/60Hz±1% (Batt. mode)
	Transfer time	4-8ms
	Waveform	Simulated Sine Wave
	No. of output sockets	3
	Protections	Overload, Short Circuit, Over Discharge & Over Charge
Battery	Battery type	12V 7Ah x 1 nos
	Charging current	1A
	Recharge time	4-6h to charge 90% (after complete discharge)
Indicators	No. of LEDs	1 LED
	AC mode	Green LED Glows
	Battery mode	Green LED blinks
Alarm	Battery mode	Beeping every 10 Secs.
	Low battery	Beeping every 1 Sec.
	Overload	Beeping every 0.5 sec.
	Fault	Continuous beeping
Physical details	Dimension	100 x 280 x 142 mm (W x D x H)
	Net. weight	4 kg
	Package dimension	323 x 143 x 215 mm (WxDxH)
Environmental factors	Operational temperature	0-40°C
	Noise level	< 40dB

Troubleshooting

Problem	Possible Cause	Solution
No LED Indicator on the front panel	Battery weak	Charge battery up to 8 hours
	Battery defect	Replace with the same type of battery
	Power switch is not pressed	Press the power switch again
Alarm buzzer beeps continuously when AC supply is normal	Overload of the UPS	Verify that the load matches the UPS capability specified in the specs
When power failure, back-up time is shorten	Overload of the UPS	Remove some non-critical load
	Battery voltage is too low	Charge battery 8 hours or more
	Battery defect due to high temperature operation environment, or improper operation to battery	Replace with the same type of battery
Green LED Blinks	Power cord is loose	Reconnect the power cord properly

If any abnormal situations occur that are not listed above, please call service person immediately.

ISO 9001:2015 Certified Company
www.zebronics.com

