



ZEBRONICS
ALWAYS AHEAD

Uninterruptible Power Supply

ZEB **U775**



POWERUP_s



User Manual

www.zebronics.com

Dear Customer,

Thank you for purchasing the **ZEB-U775** UPS. Please read the user manual carefully before usage & save it for future reference.

Important Safety Instructions

- The voltages inside UPS may be hazardous. Do not attempt to disassemble the unit. The unit contains no user serviceable parts. Only factory service personnel may perform repairs.
- Internal battery voltage is 12Vdc. sealed, lead-acid, 6 cells battery.
- Connection to any other type of socket other than a two-pole, three-wire grounded socket may result in shock hazard as well as violating to local electrical codes.
- In the event of an emergency, press the OFF button and disconnect the power cord from the AC power supply to properly disable the UPS. Do not allow liquids or any external objects to enter the UPS. Do not place beverages or any other liquid-containing vessels on or near the unit.
- This unit is designed for installation in a controlled environment (temperature controlled, indoor area free of conductive contaminants). Avoid installing the UPS in locations where there is static or flowing water, or excessive humidity.

- Do not plug the UPS input into its own output.
- Do not attach a power strip or surge suppressor to the UPS.
- Do not connect non-computer-related items, such as medical equipment, life-support equipment, microwave ovens, or vacuum cleaners to UPS.
- To reduce the risk of overheating the UPS, do not cover the UPS cooling vents and avoid exposing the unit to direct sunlight or installing the unit near heat emitting appliances such as air heaters or furnaces.
- Unplug the UPS prior to cleaning and do not use liquid or spray detergent.
- Do not dispose the batteries into fire as they may explode. Do not open or mutilate the battery or batteries. Released electrolyte is harmful to the skin and eyes. It may be toxic.
- A battery can present a risk of electrical shock and high short circuit current. The following precautions should be observed when working on batteries:
 - a) Remove watches, rings, or other metal objects from the hands.
 - b) Use tools with insulated handles.
 - c) Wear rubber gloves and boots.
 - d) Do not lay tools or metal parts on top of batteries.

- Disconnect charging source prior to connecting or disconnecting batteries terminals.
- Servicing of battery should be performed or supervised by technical and authorized personnel only.
- When replacing battery, replace with the same type of sealed lead-acid battery. The maximum ambient temperature rating is 40°C.

UPS Installation Procedure

- Your new UPS may be used immediately; however recharging the battery for atleast 8hours (no load) is recommended to ensure that the battery maximum charge capacity is achieved. Charge loss may occur during shipping and storage. To recharge the battery, simply leave the unit plugged into an AC outlet. The unit will charge in both the on and off position.
- With the UPS unit off and unplugged, connect the computer, monitor, and any externally powered data storage device (Zip drive, Jazz drive, Tape drive, etc.) into the battery power supplied outlets. DO NOT plug laser printer, copier, space heater, vacuum, paper shredder or other large electrical device into the battery power supplied outlets. The power demands of these devices will overload and possibly damage the unit.

- Plug the UPS into a 2 pole, 3 wire grounded socket (wall outlet). Make sure the wall branch outlet is protected by a fuse or circuit breaker and does not service equipment with large electrical demands (e.g. air conditioner, refrigerator, copier, etc. Avoid using extension cords.
- Press the power switch to turn the unit ON. The power on indicator light will illuminate and the unit will "beep".
- If an overload is detected, an audible alarm will sound and the unit will emit beep once every 0.5 seconds. To correct this turn the UPS off and unplug atleast one piece of equipment from the battery power supplied outlets. Wait 10 seconds Make sure the fuse is normal and then turns the UPS on.
- To maintain optimal battery charge, leave the UPS plugged into an AC outlet at all times.
- To store your UPS for an extended period, cover it and store with the battery fully charged. Recharge the battery every three months to ensure battery life.

Product Description

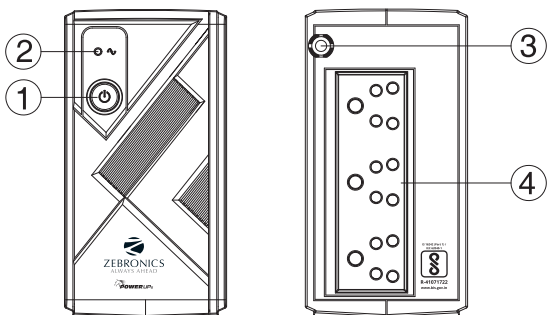

Front Panel

1. Power Switch

Press the switch for 2 seconds to turn the UPS ON or OFF.

2. Power LED

This LED is illuminated when the UPS is working.

3. Input Power Cord

Connect to utility power

4. AC Outlet

The UPS provides outlets for connected equipment to insure temporary uninterrupted operation during a power failure and against surges and spikes.

LED Indication and Alarm

Condition	Indication	Alarm
Normal	Power LED Lighting	----
Battery Discharge	Power LED flash once every 30 seconds	Beep once every 30 seconds
Battery Low	Power LED flash once every 2 seconds	Beep once every 2 seconds
Overload	Power LED flash once every 0.5 seconds	Beep once every 0.5 seconds
Fault	Power LED off	Continuous alarm

Features

- Line interactive UPS
- Auto restart while AC is recovering
- Double Boost
- Automatic Voltage Regulation (AVR)
- Wide Input Range
- Microcontroller Based
- Generator Compatible

Specifications

Capacity	(VA/W)	650VA/360W
Input	Nominal voltage	220-240 VAC
	Voltage range	140-300 VAC \pm 7 Vac
	Frequency	40-70 Hz \pm 1 Hz
	Plug type	3 Pin plug
Output	Voltage range	195-262Vac \pm 7Vac (AC mode)
	Voltage range	230VAC \pm 10 % (Batt. mode)
	Frequency range	50/60Hz \pm 1% (Batt. mode)
	Transfer time	4ms Typ.
	Waveform	Simulated Sine Wave
	No. of output sockets	3
	Protections	Overload, Short Circuit, Over Discharge & Over Charge
Battery	Battery type	12V 7Ah x 1 no
	Charging current	1.5A Typ.
	Recharge time	4h to Charge 90%
Indicators	No. of LEDs	1 LED
	AC mode	Green lighting
	Battery mode	Green flashing
Alarm	Battery mode	Beeping every 30 Secs.
	Low battery	Beeping every 2 Secs.
	Overload	Beeping every 0.5 sec.
	Fault	Continuous beeping
Physical details	Dimension	87 x 276 x 165 mm (W x D x H)
	Net. weight	4 kg
	Package dimension	319 x 126 x 235 mm (WxDxH)
Environmental factors	Operational temperature	0-40°C
	Noise level	< 40dB

Troubleshooting

Problem	Possible Cause	Solution
The UPS Does not perform expected runtime	Batteries are not fully charged	Recharge the battery by leaving the UPS Plugged in
	Battery is slightly worn out	Contact technical support
The UPS will not turn on	The on/off switch is designed to prevent damage by rapidly turning it off and on	Turn the UPS off. Wait 10 seconds and then turn the UPS on.
	The unit is not connected to an AC outlet	The unit must be connected to a 230Vac 50/60Hz outlet
	The battery is worn out	Contact technical support
	Mechanical problem	Contact technical support
Outlets do not provide power to equipment	Circuit breaker is tripped due to overload	Turn the UPS off and unplug at least one piece connected equipment. Unplug the power cord of the UPS then press the circuit breaker knob.
	Batteries are discharged	Allow the unit to recharge for at least 4 hours
	Unit has been damaged by a surge or spike	Contact technical support

If any abnormal situations occur that are not listed above, please call service person immediately.

ISO 9001:2015 Certified Company
www.zebronics.com

